



乐清市中源硬质合金有限公司

ZHONGYUAN HARD ALLOY

企业简介

Company Introduction



乐清市中源硬质合金有限公司是一家生产中高档硬质合金产品的专业厂家。厂区占地6000多平方米，现有高级工程师、技术人员50多人。

公司主要生产硬质合金三大类：K(YG)、P(YT)、M(YW)，主要产品有硬质合金圆棒、长条，硬质合金锯齿片、钻头刀片、木工铣刀、矿山产品及各种深加工异形等系列产品。目前年产量硬质合金制品300吨，产品已远销南美洲、欧洲、美国、中东等20多个国家和地区，很受客户的好评。

公司坚持把技术创新、售后服务、社会责任摆在第一位，始终把满足客户根本意愿和需求作为企业的指导核心，严格控制原材料、工艺设计、生产过程、成品检验等每个环节。

中源合金竭诚欢迎各界新老客商前来公司洽谈业务，共创美好未来！

Zhejiang Zhong Yuan Hard Alloy CO.,LTD is a professional manufacturer producing middle and high-end quality cemented carbide products. Our company covers an area of more than 6000 m², there are more than 50 technicians and engineers.

The company mainly products three series:K (YG),P(YT),M(YW). The main product: carbide rod,carbide bars,drill tips, saw tips, wood-working carbide tips,mine products and post machined products series etc. The annual output is over 300 tons.The products has been sold to the markets of South America,Europe, US,the Middle East and so on,more than 20 countries and regions, receives the favorable the favorable comment of customers.

The company Insisting on the Technology Innovation, good after-sales, Social responsibility .the customers' Intentions and needs are the company' s working core. The company strictly controls the raw materials, production artwork, art design, production process, inspection of finished products.

The Zhong Yuan welcomes all old and new customers visit and discussing businesses for better future.



生产管理 PRODUCTION MANAGEMENT



→ 以顾客为关注焦点 Take customer as attention focal point

→ 持续改进 Improves continually

→ 诚实服务 Honest service

→ 互惠双赢 The reciprocal benefit is win-win

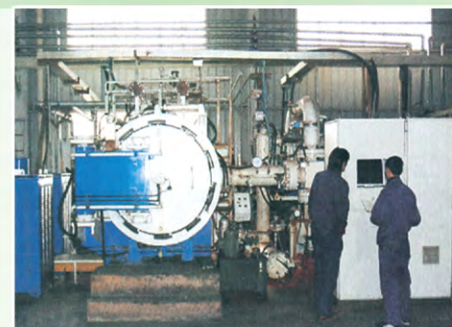

ZHONGYUAN HARD ALLOY

CONTENT 目录

- 01 / 硬质合金圆棒系列
CARBIDE ROD SERIES
- 07 / 硬质合金长条系列
CEMENTED CARBIDE FLATS
- 11 / 锯齿、木工刀系列
CEMENTED CARBIDE TIPS FOR
WOODWORKING
- 15 / 硬质合金切削刀片
CEMENTED CARBIDE CUTTING TOOLS
- 22 / 矿山、油田钻头用硬质合金
HARD METAL(CARBIDE)INSERTS FOR
MINING AND OIL-FIELD ROCK BITS
- 25 / 凿岩工具用硬质合金
HARD METAL FOR ROCK DRILLING TOOLS
- 27 / 煤炭采掘工具用硬质合金
CEMENTED CARBIDE FOR COAL-MINING
TOOLS
- 29 / 硬质合金电锤刀片
ELECTRIC HAMMER BLADE
- 31 / 旋转锉合金
ROLLING BURRS ALLOY



硬质合金圆棒 CARBIDE ROD SERIES

牌 号 Grade		YG6X
化学成份 Chemical Composition	Co	10%
	WC	89.5%
	其他 Others	0.5%
物理性能 Physical Properties	抗弯强度 TRS (MP)	≥ 3400
	硬度 Hardness(HRA)	≤ 91
	密度 Density(g/cm ³)	14.50
孔隙度 Porosity	A 类孔隙 A porosity	A02
	B 类孔隙 B porosity	B00
	非碳化物孔隙 C porosity	C00
结构 Structure	WC 晶粒度 Grain size of WC	0.7-0.8μm
推荐用途 Applications recommended		韧性和耐磨性均较好, 适于制造各类孔加工刀具。具有较好的通用性。 Good for toughness and wear resistance. For producing hole machining cutting tools. It has versatility.

牌 号 Grade		ZYH10
化学成份 Chemical Composition	Co	10%
	WC	89.5%
	其他 Others	0.5%
物理性能 Physical Properties	抗弯强度 TRS (MP)	≥ 3800
	硬度 Hardness(HRA)	≥ 91.5
	密度 Density(g/cm ³)	14.40-14.50
孔隙度 Porosity	A 类孔隙 A porosity	A02
	B 类孔隙 B porosity	B00
	非碳化物孔隙 C porosity	C00
结构 Structure	WC 晶粒度 Grain size of WC	0.4-0.6μm
推荐用途 Applications recommended		韧性和耐磨性均较好, 适于制造各类孔加工刀具。具有较好的通用性。 Good for toughness and wear resistance. For producing hole machining cutting tools. It has versatility.

牌 号 Grade		ZYH25
化学成份 Chemical Composition	Co	12%
	WC	87%
	其他 Others	1.0%
物理性能 Physical Properties	抗弯强度 TRS (MP)	≥ 4000
	硬度 Hardness(HRA)	≥ 92
	密度 Density(g/cm ³)	14.05-14.15
孔隙度 Porosity	A 类孔隙 A porosity	A02
	B 类孔隙 B porosity	B00
	非碳化物孔隙 C porosity	C00
结构 Structure	WC 晶粒度 Grain size of WC	0.5μm
推荐用途 Applications recommended		具有优良的综合性能和组织结构, 适合制作加工高温耐腐、耐热钢、不锈钢、钛合金、有色金属的整体硬质合金工具。 Good comprehensive performance and organizational structure. For producing & processing cemented carbide tools of high-temp corrosion-resistant, heat-resistant steel, stainless steel, titanium alloy and non-ferrous metals.



硬质合金圆棒 CARBIDE ROD SERIES

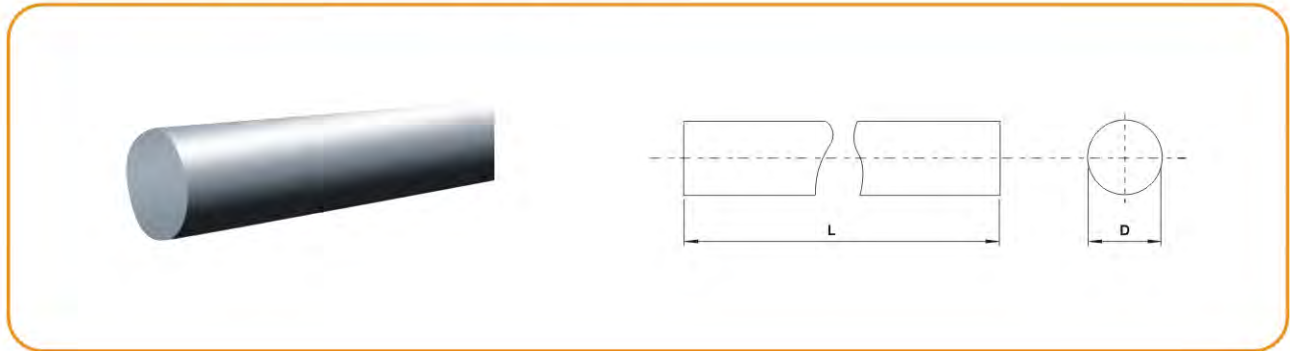

型号表示 Type: Φ 3 x 50

- 表示长度尺寸为 50mm
Code for length 50mm
- 表示外径尺寸为 3mm
Code for Outer diameter 3 mm
- 表示直径
Code “ Φ ” for diameter

粗坯平直度 straightness <0.3mm

如需其他牌号、型号，请与我们联系（直径在 3~25mm，长度在 30~152mm 范围均可生产）

Please contact us if any other brand of type is required (D 3~25mm,L30~152mm can be provided)

型号 Type	直径公差 D(mm)	长度公差 L(mm)
Φ 3x38.5	+0.2/+0.4	+0.4/+2.0
Φ 3x50	+0.2/+0.4	+0.4/+2.0
Φ 3.175x38.1	+0.2/+0.4	+0.4/+2.0
Φ 3.175x50.8	+0.2/+0.4	+0.4/+2.0
Φ 3.175x76.2	+0.2/+0.4	+0.4/+2.0
Φ 4x38.5	+0.2/+0.4	+0.4/+2.0
Φ 4x50	+0.2/+0.4	+0.4/+2.0
Φ 4x75	+0.2/+0.4	+0.4/+2.0
Φ 5x50	+0.2/+0.4	+0.4/+2.0
Φ 5x60	+0.2/+0.4	+0.4/+2.0
Φ 5x100	+0.2/+0.4	+0.4/+2.0
Φ 6x50	+0.2/+0.4	+0.4/+2.0
Φ 6x80	+0.2/+0.4	+0.4/+2.0
Φ 6x100	+0.2/+0.4	+0.4/+2.0
Φ 6x150	+0.2/+0.4	+0.4/+2.0



硬质合金圆棒 CARBIDE ROD SERIES

型号 Type	直径公差 D(mm)	长度公差 L(mm)
Φ8x60	+0.2/+0.4	+0.4/+2.0
Φ8x70	+0.2/+0.4	+0.4/+2.0
Φ8x100	+0.2/+0.4	+0.4/+2.0
Φ10x60	+0.2/+0.4	+0.4/+2.0
Φ10x70	+0.2/+0.4	+0.4/+2.0
Φ10x100	+0.2/+0.4	+0.4/+2.0
Φ12x60	+0.2/+0.4	+0.4/+2.0
Φ12x80	+0.2/+0.5	+0.4/+2.0
Φ12x100	+0.2/+0.5	+0.4/+2.0
Φ14x80	+0.2/+0.5	+0.4/+2.0
Φ14x100	+0.2/+0.5	+0.4/+2.0
Φ16x80	+0.2/+0.5	+0.4/+2.0
Φ16x90	+0.2/+0.5	+0.4/+2.0
Φ16x100	+0.2/+0.5	+0.4/+2.0
Φ16x152	+0.2/+0.5	+0.4/+2.0
Φ18x100	+0.2/+0.5	+0.4/+2.0
Φ19x150	+0.2/+0.5	+0.4/+2.0
Φ20x127	+0.2/+0.5	+0.4/+2.0
Φ20x150	+0.2/+0.5	+0.4/+2.0
Φ22x100	+0.2/+0.5	+0.4/+2.0
Φ22x150	+0.2/+0.5	+0.4/+2.0
Φ24x100	+0.2/+0.5	+0.4/+2.0
Φ24x150	+0.2/+0.5	+0.4/+2.0
Φ25x100	+0.2/+0.5	+0.4/+2.0
Φ25x127	+0.2/+0.5	+0.4/+2.0
Φ25x150	+0.2/+0.5	+0.4/+2.0



硬质合金圆棒 CARBIDE ROD SERIES

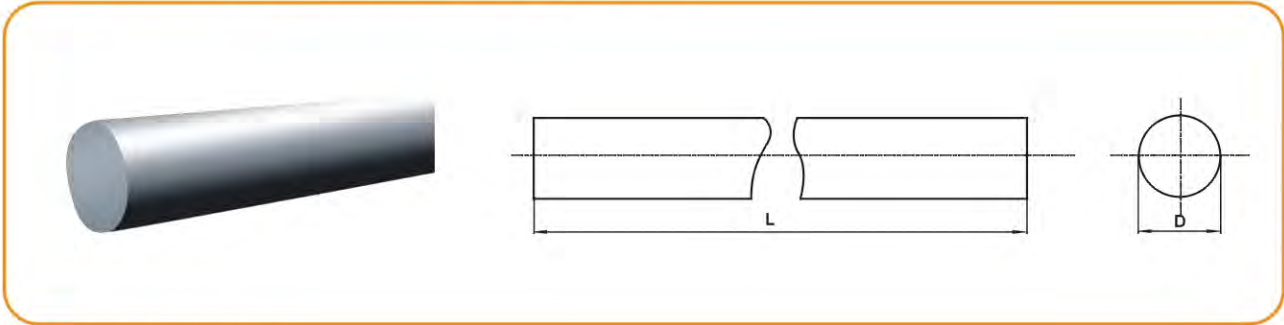

RH6 | - 0125 - 0150 - 10EF(UF)

表示中源牌号 ZY10EF(ZY10UF)
Code for ZY grade ZY10EF(ZY10UF)

表示长度尺寸为 1.5 英寸
Code for length 1.5 inch

表示外径尺寸为 0.125 英寸
Code for Outer diameter 0.125 inch

“|” 表示英制尺寸; “M” 表示公制尺寸
“|” code for inch dimension; “M” code for metric dimension

表示加工精度等级
Code for accuracy calss

型号 Type	直径 D		长度 L	
	英制 (inch)	公制及公差 (mm)	英制 (inch)	公制(公差 +1.6mm)
Φ0125x150	0.125	3.175 ⁰ _{-0.07}	1.5	38.1
Φ0125x200	0.125	3.175 ⁰ _{-0.07}	2.0	50.8
Φ0125x300	0.125	3.175 ⁰ _{-0.07}	3.0	76.2
Φ0188x200	0.188	4.763 ⁰ _{-0.07}	2.0	50.8
Φ0188x250	0.188	4.763 ⁰ _{-0.07}	2.5	63.5
Φ0188x300	0.188	4.763 ⁰ _{-0.07}	3.0	76.2
Φ0250x150	0.25	6.35 ⁰ _{-0.01}	1.5	38.1
Φ0250x300	0.25	6.35 ⁰ _{-0.01}	3.0	76.2
Φ0250x400	0.25	6.35 ⁰ _{-0.01}	4.0	101.6
Φ0250x600	0.25	6.35 ⁰ _{-0.01}	6.0	152.4
Φ0313x250	0.313	7.938 ⁰ _{-0.01}	2.5	63.5
Φ0313x300	0.313	7.938 ⁰ _{-0.01}	3.0	76.2
Φ0313x400	0.313	7.938 ⁰ _{-0.01}	4.0	101.6



硬质合金圆棒 CARBIDE ROD SERIES

型号 Type	直径 D		长度 L	
	英制 (inch)	公制及公差 (mm)	英制 (inch)	公制(公差 +1.6mm)
Φ0375x300	0.375	9.525 ⁰ _{-0.01}	3.0	76.2
Φ0375x350	0.375	9.525 ⁰ _{-0.01}	3.5	88.9
Φ0375x400	0.375	9.525 ⁰ _{-0.01}	4.0	101.6
Φ0375x600	0.375	9.525 ⁰ _{-0.01}	6.0	152.4
Φ0438x275	0.438	11.113 ⁰ _{-0.01}	2.75	69.85
Φ0438x600	0.438	11.113 ⁰ _{-0.01}	6.0	152.4
Φ0500x350	0.5	12.7 ⁰ _{-0.01}	3.5	88.9
Φ0500x400	0.5	12.7 ⁰ _{-0.01}	4.0	101.6
Φ0500x600	0.5	12.7 ⁰ _{-0.01}	6.0	152.4
Φ0563x350	0.563	14.288 ⁰ _{-0.01}	3.5	88.9
Φ0625x300	0.625	15.875 ⁰ _{-0.01}	3.0	76.2
Φ0625x350	0.625	15.875 ⁰ _{-0.01}	3.5	88.9
Φ0625x400	0.625	15.875 ⁰ _{-0.01}	4.0	101.6
Φ0625x500	0.625	15.875 ⁰ _{-0.01}	5.0	127
Φ0625x600	0.625	15.875 ⁰ _{-0.01}	6.0	152.4
Φ0750x400	0.75	19.05 ⁰ _{-0.01}	4.0	101.6
Φ0750x500	0.75	19.05 ⁰ _{-0.01}	5.0	127
Φ0750x600	0.75	19.05 ⁰ _{-0.01}	6.0	152.4
Φ1000x400	1.0	25.4 ⁰ _{-0.01}	4.0	101.6



硬质合金圆棒 CARBIDE ROD SERIES

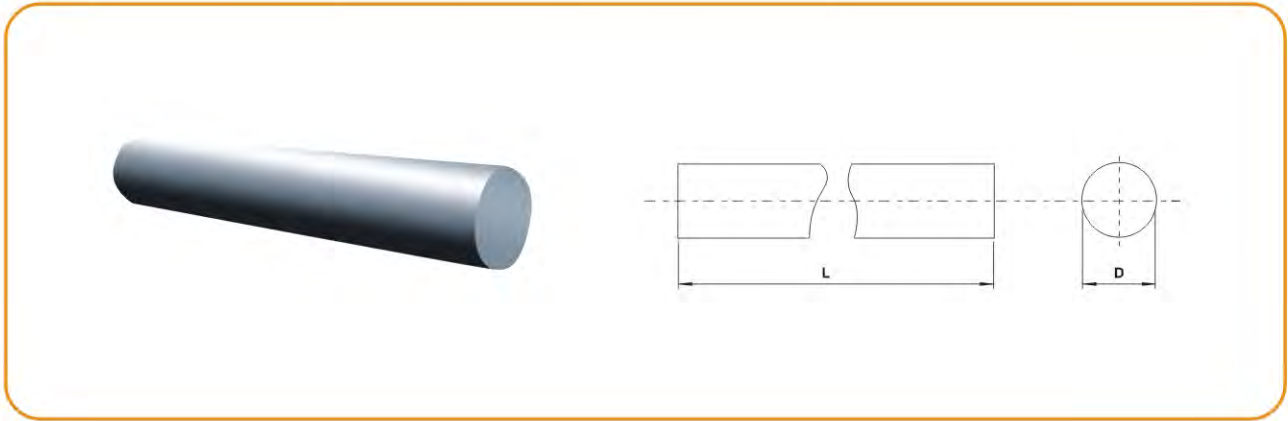

型号 Type	基本尺寸 (mm) Basic dimension		型号 Type	基本尺寸 (mm) Basic dimension	
	直径 D 公差 (mm)	长度 L 公差 (mm)		直径 D 公差 (mm)	长度 L 公差 (mm)
φ1.0x330	+0.15 +0.25	0 +3.0	φ15.5x330	+0.30 +0.50	0 +3.0
φ1.5x330			φ16.5x330		
φ2.0x330			φ17.5x330		
φ2.5x330			φ18.5x330		
φ3.0x330	+0.20 +0.30		φ19.5x330	+0.40 +0.60	
φ3.5x330			φ20.5x330		
φ4.0x330			φ21.5x330		
φ4.5x330			φ22.5x330		
φ5.0x330			φ23.5x330		
φ5.5x330			φ24.5x330		
φ6.0x330			φ25.5x330		
φ6.5x330			φ26.5x330		
φ7.0x330			φ27.5x330		
φ7.5x330			φ28.5x330		
φ8.0x330	+0.3 +0.4		φ29.5x330		
φ8.5x330					
φ9.0x330					
φ9.5x330					
φ10.0x330					
φ10.5x330					
φ11.0x330					
φ11.5x330					
φ12.0x330					
φ12.5x330					
φ13.0x330					
φ13.5x330					
φ14.0x330					
φ14.5x330					
φ15.0x330					



硬质合金长条 CEMENTED CARBIDE FLATS

牌号 Grade	化学成分(%) Chemical Composition	硬度 Hardness HRA ± 0.3	密度 Density g/cm ³ ± 0.1	抗弯强度 TRS n/mm ²	晶粒度 Grain Size μm	推荐用途 Applications recommended
	Co					
YG3X	3	93.8	15.20	1800	0.8	适于铸铁、有色金属及合金、非金属材料中等切削速度的半精加工和精加工。
YG6	6	91.5	14.90	2200	1.2~2.0	Semi-finishing and finishing of cast irons, non-ferrous metal & alloys and non metallic materials at medium cutting speed.
YG6X	6	92.5	14.90	2400	0.8	适于加工冷硬合金铸铁与耐热合金钢、也适于普通铸铁的精加工。
YG6.2A	5.5	93.5	14.60	3200	0.6	Machining of chilled alloy cast irons and refractory alloy steel of finishing of ordinary cast irons.
ZF10A	6	93.2	14.85	3500	0.7	适用于各种铸铁及有色金属的精加工和半精加工，也可制作整体刀具。 Suitable for fine finishing and semi finishing for various cast irons and non-ferrous metal, also suitable for whole cutting tool making.
YG8	8	90.5	14.70	2500	1.2~2.0	适于铸铸铁、有色金属及合金、非金属材料低速粗加工。
YG8H	8.5	91.0	14.50	2000	1.2~2.4	Roughing of cast iron, non-ferrous metals & alloys as well as non metallic materials at low cutting speed.
YW2	8	92.0	13.20	2800	0.8	适于耐磨钢、高锰钢、不锈钢及高级合金等的粗加工、半精加工，也适于普通钢和铸铁。 Roughing and medium machining of ordinary steel, high manganese steel, stainless steel and advanced alloy steel.



硬质合金长条 CEMENTED CARBIDE FLATS

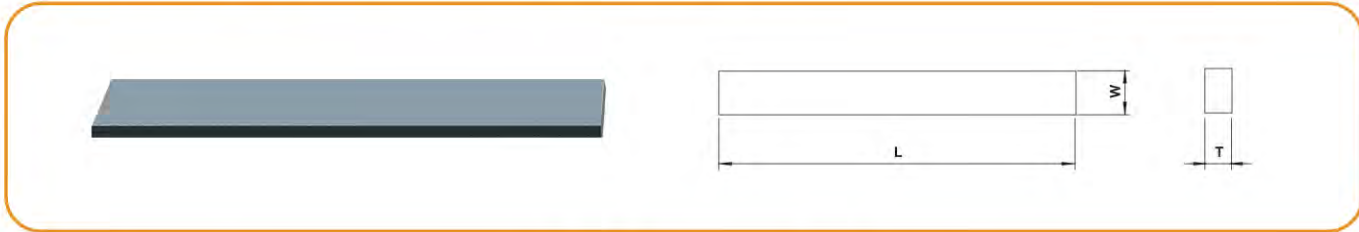

型号 Type	基本尺寸 (mm)		Basic dimension	
	T +0.5 +0.2	W +0.6 +0.3	L +1.0 0	
2x2x330	2	2	330	
2x3x330	2	3	330	
2x4x330	2	4	330	
2x5x330	2	5	330	
2x6x330	2	6	330	
2x7x330	2	7	330	
2x8x330	2	8	330	
2x10x330	2	10	330	
2x12x330	2	12	330	
2x13x330	2	13	330	
2x14x330	2	14	330	
2x15x330	2	15	330	
2x16x330	2	16	330	
2x18x330	2	18	330	
2x19x330	2	19	330	
2x20x330	2	20	330	
2x25x330	2	25	330	
2.9x5.8x330	2.9	5.8	330	

◇带角度硬质合金板条产品
Cemented carbide flats with angle

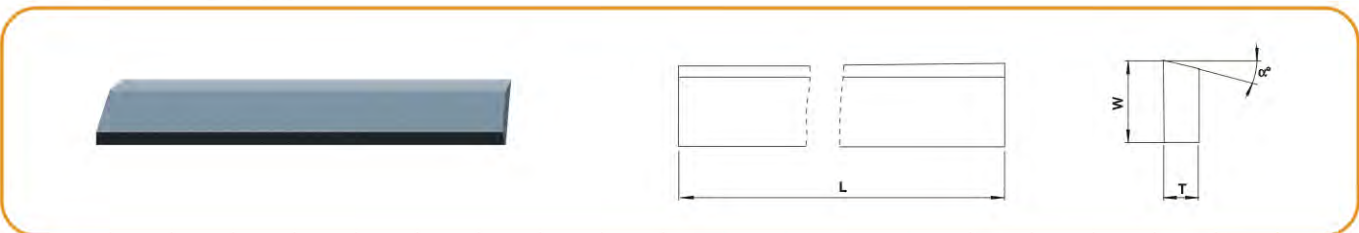

型号 Type	基本尺寸 (mm)			Basic dimension	
	T +0.5 +0.2	W +0.6 +0.3	L +1.0 0	α°	$\pm 1.0^\circ$
2.5x3.9x330-8	2.5	3.9	330	8	
2.6x4x330-12	2.6	4	330	12	
3x4.5x330-8	3	4.5	330	8	
3x4.9x330-8	3	4.9	330	8	
3.1x5x330-10	3.1	5	330	10	
3.6x6x330-8	3.6	6	330	8	
5x7x330-8	5	7	330	8	



硬质合金板材 CEMENTED CARBIDE RECTANGULAR BLANKS

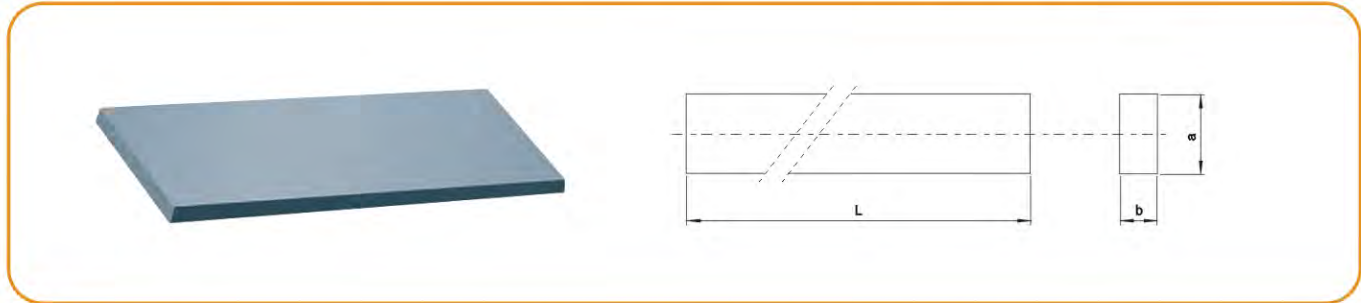

型号 Type	基本尺寸 (mm) Basic dimension			型号 Type	基本尺寸 (mm) Basic dimension		
	宽 a 公差 mm	厚 b 公差 mm	长度 L 公差 mm		宽 a 公差 mm	厚 b 公差 mm	长度 L 公差 mm
3x2x330	+0.2 +0.4			15x2x330	+0.4 +0.6	+0.15 +0.35	0 +3.0
4x3x330				15x3.5x330			
5x2x330				15x4x330			
5x3.5x330				16x3x330			
5.5x1x330				17x3x330			
6x3x330				17x5x330			
8x2x330				18x2x330			
8x3x330				18x3.5x330			
10x2x330				20x2x330			
10x2.5x330				20x3x330			
10x3x330	20x3.5x330						
10x3.5x330	20x5x330						
12x2x330	+0.3 +0.5			22x3.5x330	+0.4 +0.6	+0.15 +0.35	0 +3.0
12x2.5x330				22x4x330			
12x3x330				25x3.5x330			
12x3.5x330				25x4x330			
12x4.5x330				30x5x330			
12x5x330				32x3x330			
14x3x330				34x3x330			



硬质合金刨刀片系列 CARBIDE KNIVES SERIES

A型(A Type)

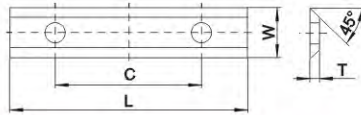
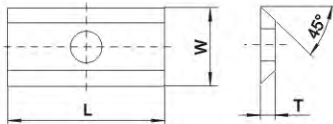

DIMENSION mm			
L	W	T	C
7.6	12.0	1.5	-
15.0	12.0	1.5	-
20.0	12.0	1.5	-
30.0	12.0	1.5	14
40.0	12.0	1.5	26
50.0	12.0	1.5	26
60.0	12.0	1.5	26

INDEXABLE KNIVES FOR REBATING CUTTER
Natural wood
DIMENSION
12x12x1.5-08
15x12x1.5-08
20x12x1.5-08
30x12x1.5-08
40x12x1.5-08
50x12x1.5-08
60x12x1.5-08
Cutting of MDF and laminated boards
12x12x1.5-06
14x14x2.0-06
15x12x1.5-06
20x12x1.5-06
30x12x1.5-06
40x12x1.5-06
50x12x1.5-06
60x12x1.5-06
Laminated chip boards KORIAN-Hardwood
20x12x1.5-02
30x12x1.5-02
50x12x1.5-02

B型(B Type)

型号 Type	基本尺寸 General size		
	L	B	C
P01	50	8	1.7
P02	65	8	1.8

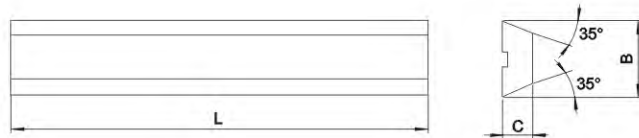



硬质合金锯片 CEMENTED CARBIDE SAW BITS

MKWPRL- 系列锯片 MKWPRL-series saw bit

型号 Type	B	型号 Type	B
MKWPRL-06	6.2	MKWPRL-20	20.2
MKWPRL-08	8.2	MKWPRL-25	25.2
MKWPRL-10	10.2	MKWPRL-30	30.2
MKWPRL-12	12.2	MKWPRL-40	40.2
MKWPRL-14	14.2	MKWPRL-50	50.2
MKWPRL-16	16.2	MKWPRL-60	60.2
MKWPRL-18	18.2	MKWPRL-80	80.2

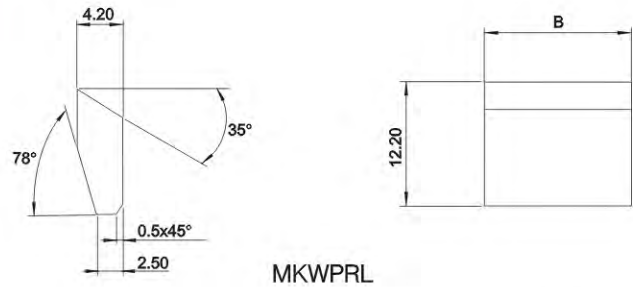

MKWPR- 系列锯片 MKWPR-series saw bit

型号 Type	B	型号 Type	B
MKWPR-07	7.2	MKWPR-16	16.2
MKWPR-08	8.2	MKWPR-18	18.2
MKWPR-09	9.2	MKWPR-20	20.2
MKWPR-10	10.2	MKWPR-25	25.2
MKWPR-12	12.2	MKWPR-30	30.2
MKWPR-14	14.2		

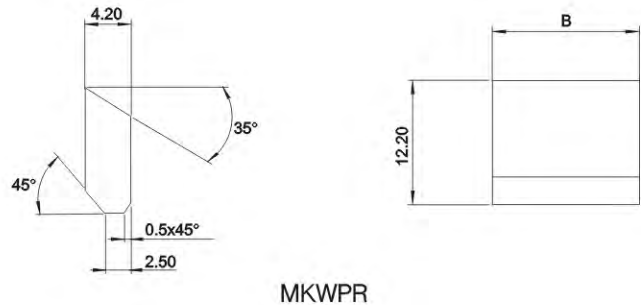

MKW- 系列锯片 MKW-series saw bit

型号 Type	B
MKW-062019	2.0
MKW-063019	3.0
MKW-064019	4.0
MKW-065019	5.0

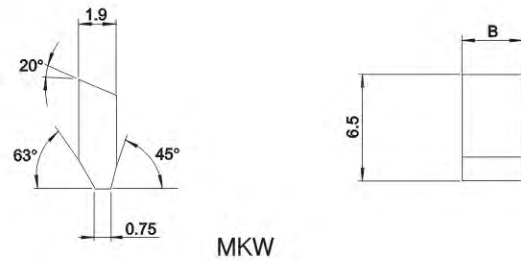

MKW- 系列锯片 MKW-series saw bit

型号 Type	B
MKW-083522	3.6
MKW-084022	4.0
MKW-084522	4.5
MKW-085022	5.0
MKW-085522	5.5
MKW-086022	6.0

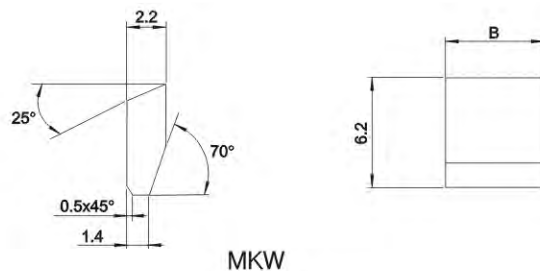

MKW- 系列锯片 MKW-series saw bit

型号 Type	B	型号 Type	B
MKW-092822	2.8	MKW-095022	5.0
MKW-093622	8.6	MKW-095522	5.5
MKW-093822	3.8	MKW-096022	6.0
MKW-094022	4.0	MKW-096522	6.5
MKW-094322	4.3	MKW-097022	7.0
MKW-094522	4.5		

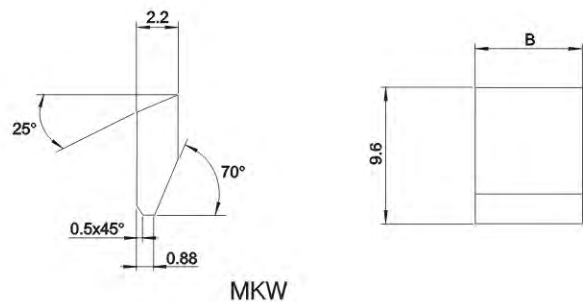



硬质合金锯片 CEMENTED CARBIDE SAW BITS

MKW-系列锯片 MKW-series saw bit

型号 Type	B
MKW-093025	3.0
MKW-094025	4.0
MKW-095025	5.0
MKW-096025	6.0

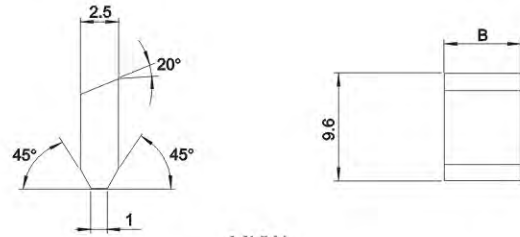

MKW

MKW-系列锯片 MKW-series saw bit

型号 Type	B	型号 Type	B
MKW-093032	2.8	MKW-094032	4.0
MKW-093632	8.6	MKW-094332	4.3
MKW-093832	3.8	MKW-094532	4.5

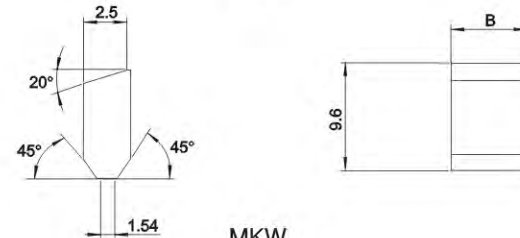

MKW

MKW-系列锯片 MKW-series saw bit

型号 Type	B	型号 Type	B
MKW-103525	3.5	MKW-105025	5.0
MKW-104025	4.0	MKW-105525	5.5
MKW-104525	4.5	MKW-106025	6.0

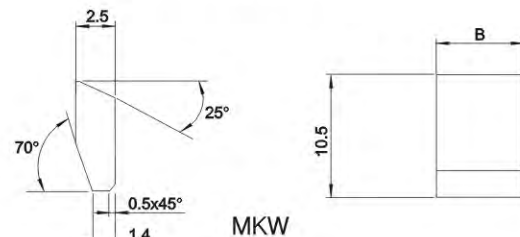

MKW

MKW-系列锯片 MKW-series saw bit

型号 Type	B	型号 Type	B
MKW-103035	3.0	MKW-105035	5.0
MKW-103535	3.5	MKW-105535	5.5
MKW-104035	4.0	MKW-106035	6.0
MKW-104335	4.3	MKW-106535	6.5
MKW-104535	4.5		

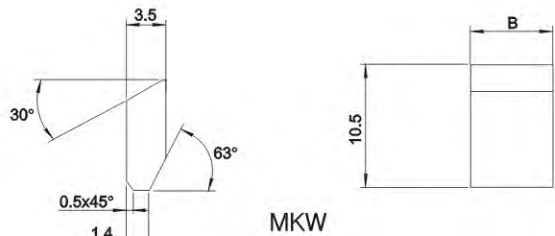

MKW

MKW-系列锯片 MKW-series saw bit

型号 Type	B
MKW-123026	3.0
MKW-124026	4.0
MKW-125026	5.0
MKW-126026	6.0

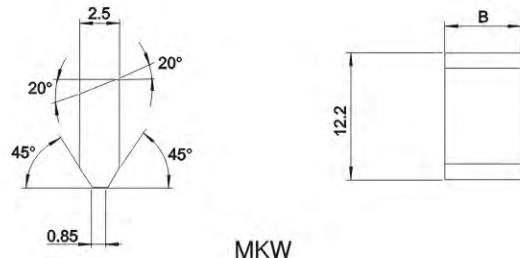

MKW

MKW-系列锯片 MKW-series saw bit

型号 Type	B
MKW-145240	5.2
MKW-146240	6.2
MKW-147240	7.2
MKW-148240	8.2
MKW-149240	9.2

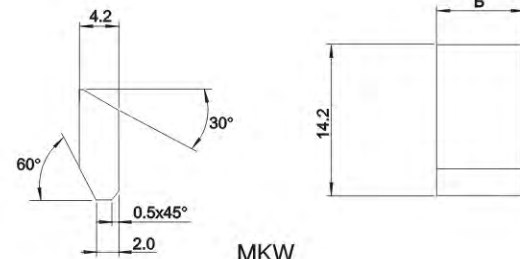

MKW



木工合金刀片 ALLOY BLADE FOR WOOD CUTTER

户西侧板刀刀片 Huxi sideboard blade

编号 规格	F x ZB001 3/4	002 7/8	003 1	004 1 1/8	005 1 1/4	006 1 3/8	007 1 1/2
L	22.1	25.2	28.4	31.6	34.8	37.9	41.1
L ₁	3.2	3.2	6	6	6	6	6
L ₂	18.9	22	12	12	12	12	12
L ₃	4.66	6.31	8.09	9.26	9.38	11.53	13.42
H	11.6	13.2	14.8	16.4	16.4	18	19.6
h	11.6	13.2	10	10	10	10	10
r	11.6	11.77	12.07	13	15.9	15.73	16.02
R	40	40	60	60	60	60	60

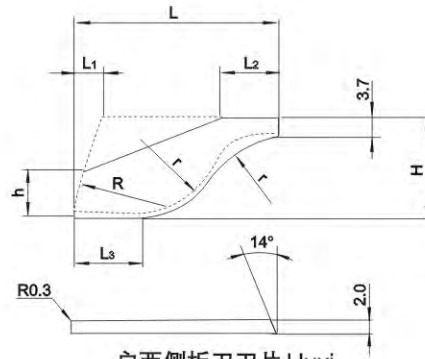

户西侧板刀刀片 Huxi sideboard blade

清底刀刀片 Cleanout cutter blade

编号 规格	QD001 5/16	002 3/8	003 1/2	004 5/8	005 3/4	006 7/8	007 1	008 1 1/4	009 1 1/2	010 2
A	2	3	3	4.5	4.8	6	8	10.5	14.6	20.5
B	5.2	6	7.5	9.2	10.7	12.3	14	17.2	20.3	26.6
L	13.5	13.5	16.5	16.5	16.5	16.5	16.5	16.5	15.5	15.5
H	1.2	1.2	1.2	1.5	1.5	1.5	2	2	2	2
R	50	50	50	50	50	50	40	40	40	40

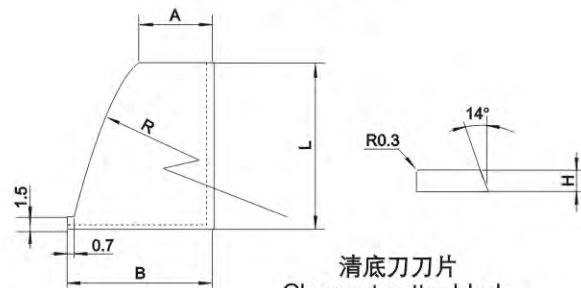

清底刀刀片 Cleanout cutter blade

半梅线刀刀片 Half rose line blade

编号 规格	BM x 001 3/8	002 1/2	003 5/8	004 3/4	005 7/8	006 1	007 1 1/8
L	7.8	9.4	11	12.5	14.1	15.7	17.3
H	17	21	24	28	31	34	36
B	9	12.2	15.4	18.5	21.6	24.8	28
h	4	4.4	4.3	4.75	4.7	4.6	4
r	2.38	3.175	3.98	4.75	5.55	6.35	7.15
R	40	40	40	40	40	50	60
B ₁	4.24	5.85	7.44	9	10.5	12.1	13.7

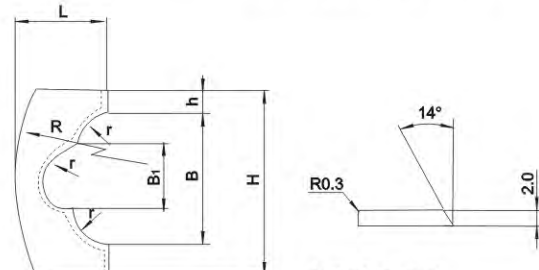

半梅线刀刀片 Half rose line blade

三珠饰刀刀片 Three pearlite blade

编号 规格	SZSD001 7/8	002 1	003 1 1/8	004 1 1/4 7/8	005 1 3/8	006 1 7/16
A	3.9	4.7	5.1	5.5	5.9	6.3
H	22.2	25.4	28.6	31.8	34.9	36.5
h	4.33	5.8	6.67	7.47	8.17	8.97
h ₁	2.6	2	2.3	2.7	2.7	2.3
h ₂	2	2	2	2	2.5	2.5
r	2.38	3.11	3.56	3.96	4.36	4.75
R	40	40	40	50	60	60

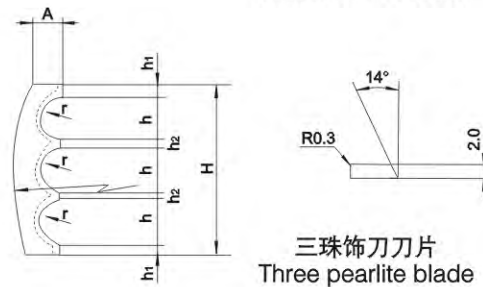

三珠饰刀刀片 Three pearlite blade

双蝶弧线刀刀片 Double butterfly arc blade

编号 规格	F x ZB001 3/4	002 7/8	003 1	004 1 1/8 1	005 1 1/4	006 1 3/8	007 1 1/2
L	22.1	25.2	28.4	31.6	34.8	37.9	41.1
L ₁	3.2	3.2	6	6	6	6	6
L ₂	18.9	2.2	6	6	6	6	6
L ₃	19.72	22.82	26.02	29.22	32.42	34.73	37.93
H	10	11.6	13.2	14.8	16.4	16.4	16.4
h ₁	6.36	7.69	9.01	10.33	11.65	10.72	10.44
h ₂	10	11.6	10	10	10	10	10
r	2.38	2.38	2.38	2.38	2.38	3.17	3.17
R	40	40	60	60	60	60	60

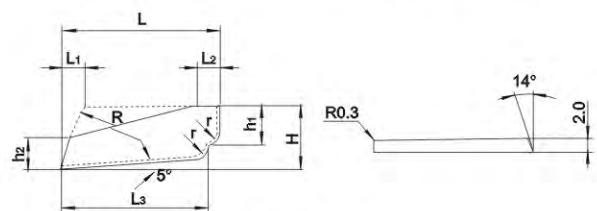

双蝶弧线刀刀片



木工合金刀片 ALLOY BLADE FOR WOOD CUTTER

魔术刀刀片 Magic knife blade

编号 规格 尺寸	MSD001 7/8	002 1	003 1 1/8	004 1 1/4	005 1 3/8	006 1 1/2	007 1 3/4
L	12.7	16.2	17.8	19.4	21	22.6	25.6
L ₁	7.3	9.9	10.7	11.5	12.3	13	14.6
L ₂	1.6	1.6	1.6	1.6	1.6	1.6	1.6
L ₃	3.7	4.75	5.55	6.35	7.1	7.95	9.4
H	26	29	32.2	35.3	38.5	41.7	48
h ₁	5.2	5.2	5.2	5.2	5.2	5.2	5.2
h ₂	3.96	4.76	5.55	6.35	7.92	9.5	11.1
h ₃	1.6	1.6	2.38	2.38	2.38	2.38	2.38
h ₄	2.38	3.17	3.17	3.96	3.96	4.75	5.55
h ₅	3.96	4.76	5.55	6.35	7.15	7.96	9.52
h ₆	3.4	6.4	6.2	9.8	9.5	12.6	18
r ₁	1.98	2.38	2.78	3.17	3.96	4.75	5.55
r ₂	2.38	3.17	3.17	3.96	3.96	4.75	5.55
r ₃	3.96	4.76	5.55	6.35	7.15	7.96	9.52
r ₄	8.73	9.52	10.3	11.1	11.9	12.7	14.3
R ₁	0	20	25	25	30	30	35
R ₂	0	20	25	25	25	25	25
R ₃	40	40	50	50	60	60	60

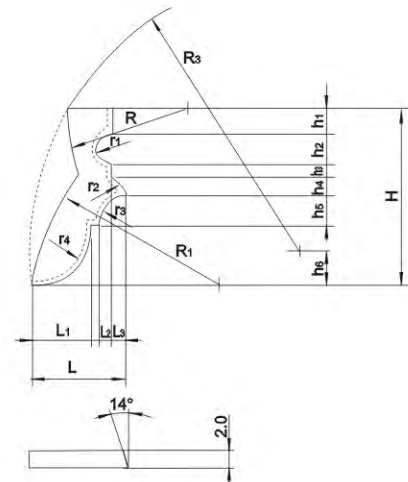

魔术刀刀片
Magic knife blade

龙珠金圆刀刀片 Dragon ball golden round cutter blade

编号 规格 尺寸	LZ001 3/8	002 1/2	003 5/8	004 3/4	005 7/8	006 1	007 1 1/8	008 1 1/4	009 1 1/2	010 2
A ₁	3	3.5	3.5	4	5	6	6	7	8	10
A ₂	3	5	7	9	9.5	10	11.5	13	15	19
B	9.5	12	14.5	17	18.5	20	21.5	24	27	33
B ₁	5.3	7	8.5	10	11.5	13	15	16.5	19.5	26
L ₁	2.3	3	4	5	5	5	5	6	7	8
L ₂	2.6	3.6	5.2	6.4	6.5	7.8	8.3	9.0	9.5	10.4
L ₃	5	5	5	6	6	6	6	6	7	7
L	9	9.5	11	12.5	12.5	14	14.5	15	15.5	16.5
R ₁	5.7	7.5	8.7	10.2	12.7	14.3	16.5	17.75	23.38	36.1
R ₂	6.35	7.9	9.5	10.3	11.1	12.7	14.3	15.9	19.1	25.4
R ₃	40	40	40	40	40	40	40	40	40	40

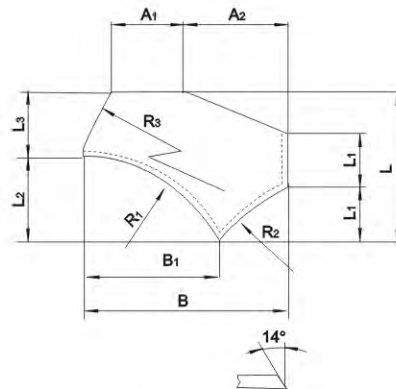

龙珠金圆刀刀片
Dragon ball golden round cutter blade

双边门斗条线刀刀片

编号 规格 尺寸	SBMD001 3/8	002 1/2	003 5/8	004 3/4	005 7/8	006 1	007 1 1/8	008 1 1/4	009 1 1/2
A	9.6	12	15.1	18.5	21.5	24.7	27.9	32.7	40.6
A ₁	2	4.4	7.5	6	6	6	8	10	13
A ₂	5.4	6.8	8.3	9.9	11.5	13.2	14.8	18	21.1
A ₃	2.38	3.17	4.76	6.35	7.96	9.52	11.1	12.7	17.5
r ₁	2.38	3.17	4.76	6.35	7.96	9.52	11.1	12.7	17.5
r ₂	3.17	4.76	6.35	7.9	9.5	11.1	12.7	15.9	19.0
H	10	13.2	16.4	19.5	22.5	25.9	29	32.3	40.5
h	4.45	5.27	5.3	5.3	5.1	5.3	5.2	3.7	4
h ₁	2.38	3.17	4.73	6.35	7.96	9.52	11.1	12.7	17.5
h ₂	10	13.2	16.4	10	10	10	12	13	14
B	7.6	7.6	7.6	7.6	8	8	8	8	8
R	30	30	30	30	40	40	50	60	60

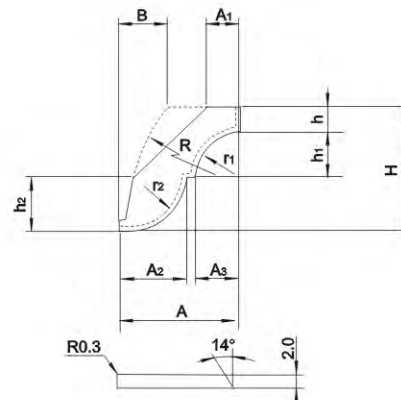

双边门斗条线刀刀片



硬质合金牌号和性能及用途 CEMENTED CARBIDE GRADE AND PROPERTY

型号 Type	ISO 分类 代号 ISO Code	性能 Performance			用途 Application
		密度 Density	抗弯强度 TRS	硬度 Density	
		G/cm ³	N/mm ²	HRA	
YT5	P30	12.5-13.2	≥ 1500	≥ 89.5	适合加工碳素钢与合金钢(包括钢锻件、冲压件及铸件的表皮)不平整面与间断切削时的粗车、粗刨、半精刨、非连续的粗铣及钻孔。 Fitting gruff milling,gruff planing, half-extract planing in smooth-less surface and interrupted cutting in processing carbon steel and alloy, steel including steel forged-assessory struck and compressed accessory, and the outover of cast accessoy, noncontinuous gruff milling and drilling.
YW1	M10	12.7-13.5	≥ 1290	≥ 91.5	耐热钢、高锰钢及普通钢和铸铁的加工。 Processing of heat-resistant steel,high manganese steel,ordinary steel,and forged iron.
YW4	M10	12-12.6	≥ 1230	≥ 91.5	加工不锈钢,亦可作普通合金钢(铁、镍除外)的加工。 Processing of ordinary alloy steel(excluding iron and nickle)as well as stainless steel.
YW2	M20	12.5-13.5	≥ 1460	≥ 90.5	耐热钢、高锰钢及普通钢和铸铁的半精加工。 Half-extract processing of heat-resistant steel,high manganese steel,ordinary steel and cast iron.
YG3	K01	14.9-15.3	≥ 1180	≥ 90.5	适合铸铁、有色金属及其合金与非金属材料(橡皮、纤维、塑料、板岩、玻璃及石墨电极等)连续切削时的精车,半精车及小断面精车。 精车螺纹与扩孔,切割玻璃,并能作钢、有色金属及其合金线材的湿式润滑拉伸,非金属材料 的钻孔等。 Fitting extract milling, half-extract milling and small dimension milling in continuous cutting of cast iron, Coloured metal and its alloy, and unallied material(rubber, fiber, plastic, plank rock glass and black lead electroad, etc)extract machine whorling and hole expanding; glass incising; wet lubricated plucking of steel, Coloured metal and its allied string material; hole-drilling in nonmetal material.etc
YG6X	K10	14.8-15.1	≥ 1420	≥ 91	适合冷硬铸铁、合金铸铁、耐热钢、合金钢的加工,亦适于普通铸铁之精加工。 Fitting processing of cold or heat cast iron,alloy cast iron,heat-resistant steel,allied steel ,and extract processing of ordinary cast iron.
YG6	K20	14.7-15.1	≥ 1520	≥ 89.5	适于铸铁、有色金属及其合金与非金属材料连续切削时的精车、间断切削时的半精车、精车、小断面精车、粗车螺纹、旋风车丝、连续断面的半精铣与精铣、孔的粗扩、也用于钢、有色金属及其合金线材的干式润滑拉伸、地质勘探、煤炭采掘用电钻及风钻头、制造机器与工具的易磨损零件。 Fitting extract processing in nonstop cutting of cast iron,Coloured metal and its alloy and nonmetal material;half-extract processing,extract processing,small-dimension extract processing,and gruff machine whorling in interrupted cutting; half-extract milling and extract milling of continuous surface and vortex machining string,gruff expanding of hole;dry lubricated plucking of steel,Coloured metal,and its alloy string material.earth surveying;serving as the drill-head in wind-drill and electric drill of coal digging and the fray-able accessory of manufacturing machine and tool.
YG8N	K20-K30	14.5-14.9	≥ 1670	≥ 90.0	硬铸铁、球墨铸铁、白口铁及有多金属精加工。 Extract procesing of hard cast iron,ball-ink cast iron,white-mouthed iron and coloured metal.
YG8	K20-K30	14.5-14.9	≥ 1780	≥ 89.0	适于铸铁、有色金属及其合金与非金属材料加工中不平整断面和间断切削时的粗车、粗刨、精洗、一般孔和深孔的钻孔、扩孔。钢、有色金属及其合金的棒材与管材的拉伸、电钻钻头、切煤机齿、油井钻头、地质探钻头,制造机器及工具的易磨损零件。如喷咀、顶尖、导向装置,顶锻杆及穿孔工具、木工刀片等。 Fitting gruff processing ,gruff planing,and extract milling in interrupted cutting and smooth-less surface in processing of cast iron,Coloured metal and its alloy,and nonmetal material; drilling and expanding of ordinary and deep hole;plucking of stick and pipe material of Coloured metal and its alloy;serving as head of electric drill, tooth of coal-cutting machine, head of oil-well drills,and head of drills in earth surueying, etc; frayable accessory of manufacturing machine and tool,e.g.spout, finial, guiding-set, top forging-pole,hole-shuttling tool, and wood cutter.



硬质合金切削刀片 CEMENTED CARBIDE CUTTING TOOLS

>>A

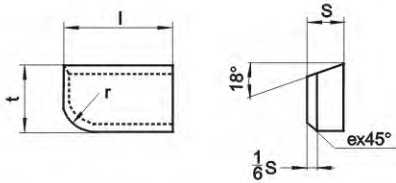

型号 Type	尺寸 Size(mm)			
	l	t	s	r
A5	5	3	2	2
A6	6	4	2.5	2.5
A8	8	5	3	3
A10	10	6	4	4
A12	12	8	5	5
A16	16	10	6	6
A20	20	12	7	7
A25	25	14	8	8
A32	32	18	10	10
A40	40	22	12	12
A50	50	25	14	14

>>B

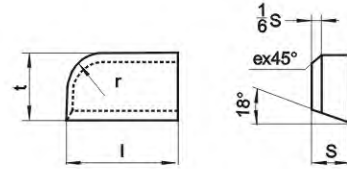

型号 Type	尺寸 Size(mm)			
	l	t	s	r
B5	5	3	2	2
B6	6	4	2.5	2.5
B8	8	5	3	3
B10	10	6	4	4
B12	12	8	5	5
B16	16	10	6	6
B20	20	12	7	7
B25	25	14	8	8
B32	32	18	10	10
B40	40	22	12	12
B50	50	25	14	14

>>C

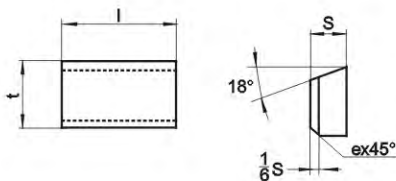

型号 Type	尺寸 Size(mm)		
	l	t	s
C5	5	3	2
C6	6	4	2.5
C8	8	5	3
C10	10	6	4
C12	12	8	5
C16	16	10	6
C20	20	12	7
C25	25	14	8
C32	32	18	10
C40	40	22	12
C50	50	25	14

>>D

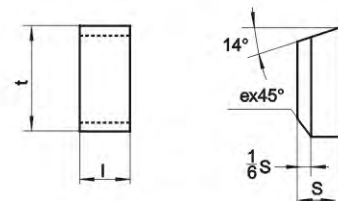

型号 Type	尺寸 Size(mm)		
	l	t	s
D3	3	8	3
D4	4	10	4
D5	5	12	5
D6	6	14	6
D8	8	16	8
D10	10	18	10
D12	12	20	12



硬质合金切削刀片 CEMENTED CARBIDE CUTTING TOOLS

>>E

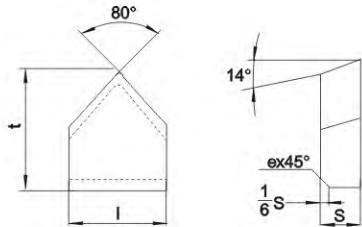

型号 Type	尺寸 Size(mm)		
	l	t	s
E4	4	10	2.5
E5	5	12	3
E6	6	14	3.5
E8	8	16	4
E10	10	18	5
E12	12	20	6
E16	16	22	7
E20	20	25	8
E25	25	28	9
E32	32	32	10

>>G

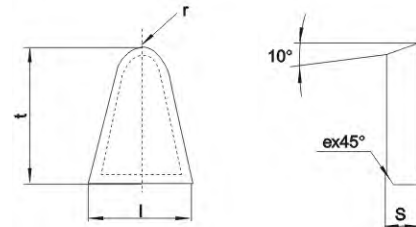

型号 Type	尺寸 Size(mm)			
	l	t	s	r
G8	8	12	4	1
G10	10	14	4	1.5
G12	12	17	5	2.5
G16	16	20	6	3.5
G20	20	24	6	4.5
G25	25	28	8	6
G30	30	34	10	8

>>K

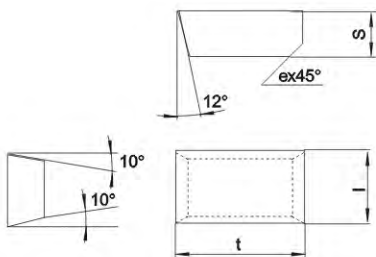

型号 Type	尺寸 Size(mm)		
	l	t	s
K2	2.5	15	4
K3	3.5	15	4
K4	4.5	15	4
K5	5.5	15	4
K6	6.5	15	4
K7	7.5	15	4
K8	8.5	20	6
K9	9.5	20	6
K10	10.5	20	6
K12	12.8	20	6

基本尺寸 General size (mm)	<6	>6~12	>12~25	>25~50	>50
允许偏差 Tolerance	+0.3 0	+0.4 0	+0.6 0	+1.0 0	+2.0 0



硬质合金切削刀片 CEMENTED CARBIDE CUTTING TOOLS

A1 型制造外圆车刀、镗刀和槽刀

A1 type for cylindrical turning tool, boring cutter and facing tool

型号 Type	尺寸 Size(mm)			
	L	B	C	e
A106	6	5	2.5	-
A108	8	7	3.0	-
A110	10	6	3.5	0.8
A112	12	10	4.0	0.8
A114	14	12	4.5	0.8
A116	16	10	5.5	0.8
A118	18	12	7.0	0.8
A118A	18	16	6.0	0.8
A120	20	12	7.0	0.8
A122	22	15	8.5	0.8
A122A	22	18	7.0	0.8
A125	25	15	8.5	0.8
A125A	25	20	10	0.8
A130	30	16	10	0.8
A136	36	20	10	0.8
A140	40	18	10.5	1.2
A150	50	20	10.5	1.2

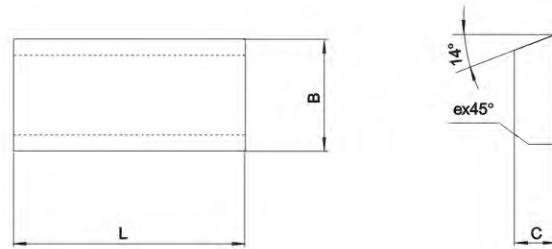

A1 型

A2 型制造镗刀和端面车刀

A2 type for boring cutter and facing tool

型号 Type		尺寸 Size(mm)				
右	左	L	B	C	R	e
A208	-	8	7	2.5	6	-
A210	-	10	8	3.0	6	-
A212	A212Z	12	10	4.5	10	0.8
A216	A216Z	16	14	6	14	0.8
A220	A220Z	20	18	7	18	0.8
A225	A225Z	25	20	8	20	0.8

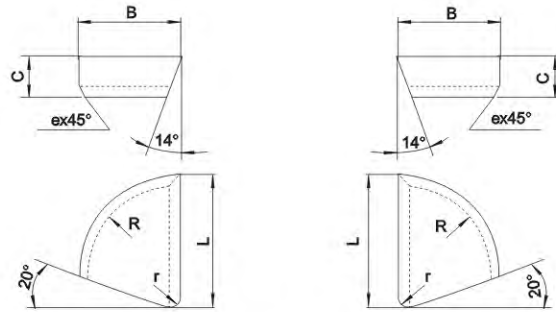

右

A2 型

左

A3 型制造端面车刀和外圆车刀

A3 type for facing tool and cylindrical turning tool

型号 Type		尺寸 Size(mm)				
右	左	L	B	C	R	e
A318	-	10	6	3	6	-
A312	A312Z	12	7	4	7	0.8
A315	A315Z	15	9	6	9	0.8
A320	A320Z	20	11	7	11	0.8
A325	A325Z	25	14	8	14	0.8
A330	A330Z	30	16	9.5	16	0.8
A340	A340Z	40	18	10.5	18	1.2

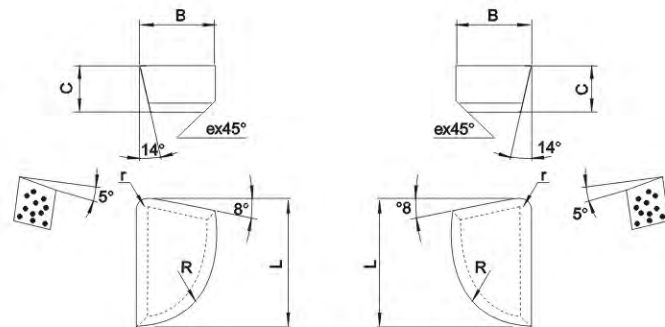

右

A3 型

左



硬质合金切削刀片 CEMENTED CARBIDE CUTTING TOOLS

A4 型制造外圆车刀、镗刀和端面车刀
A4 type for cylindrical turning tool、boring cutter and facing tool

型号 Type		尺寸 Size(mm)				
右	左	L	B	C	R	e
A406	-	6	5	2.5	6	-
A408	-	8	6	3	6	-
A410	A410Z	10	6	3.5	6	0.8
A412	A412Z	12	8	4.5	8	0.8
A416	A416Z	16	10	5.5	10	0.8
A420	A420Z	20	12	7	12.5	0.8
A425	A425Z	25	15	8.5	16	0.8
A430	A430Z	30	16	6	16	0.8
A430A	A430AZ	30	16	9.5	16	0.8
A440	A440Z	40	18	8	18	0.8
A440A	A440AZ	40	18	10.5	18	1.2
A450	A450Z	50	20	8	20	0.8
A450A	A450AZ	50	20	12	20	1.2

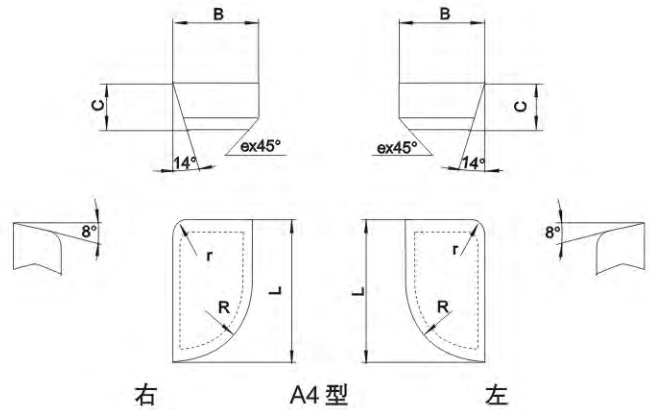

B1 型制造成型车刀、燕尾槽铣刀和燕尾槽刨刀
B1 type for shaping turning tool、dovetail groove cutter and dovetail groove wound cutter

型号 Type		尺寸 Size(mm)				
右	左	L	B	C	R	e
B108	-	8	6	3	1.5	-
B112	B112Z	12	8	4	1.5	1
B116	B116Z	16	10	5	1.5	1
B120	B120Z	20	14	5	1.5	1
B120A	B120AZ	20	16	7	1.5	1.5
B125	B125Z	25	14	5	1.5	1.5
B125A	B125AZ	25	18	8	1.5	1.5
B130	B130Z	30	20	8	1.5	1.5

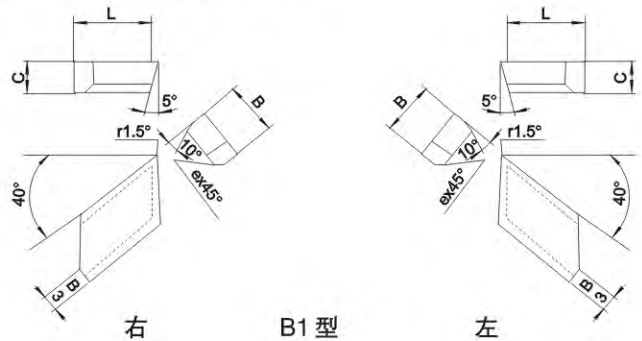

B2 型制造凹圆弧成型车刀和轮缘车刀
B2 type for concave circular arc shaping turning tool and flange turning tool

型号 Type		尺寸 Size(mm)				
右	左	L	B	C	R	e
B208	-	8	8	3	4	-
B210	-	10	10	3.5	5	0.8
B212	-	12	12	4.5	6	0.8
B214	-	14	16	5	8	0.8
B216	-	16	20	6	10	0.8
B220	-	20	25	7	12.5	0.8
B225	-	25	30	8	15	0.8
B228	-	28	35	9	17.5	0.8

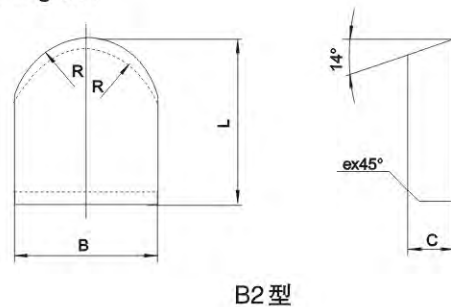

B3 型制造凸圆弧成型车刀
B3 type for convex circular arc shaping turning tool

型号 Type		尺寸 Size(mm)				
右	左	L	B	C	R	e
B312	B312Z	12	8	4	8	3
B315	B315Z	16	10	5	10	5
B318	B318Z	18	12	6	12	6
B322	B322Z	22	16	7	16	10

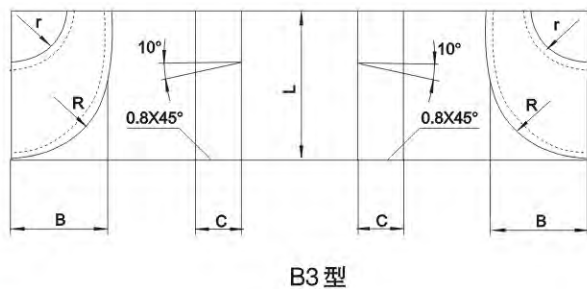



硬质合金切削刀片 CEMENTED CARBIDE CUTTING TOOLS

C1 型制造螺纹车刀及外圆精车刀

C1 type for screw turning tool and cylindrical refined turning tool

型号 Type	尺寸 Size(mm)				
	L	B	C	r	e
C110	10	4	3	0.5	-
C116	16	6	4	0.5	-
C120	20	8	5	0.5	0.8
C122	22	10	6	0.5	0.8
C125	25	12	7	0.5	0.8

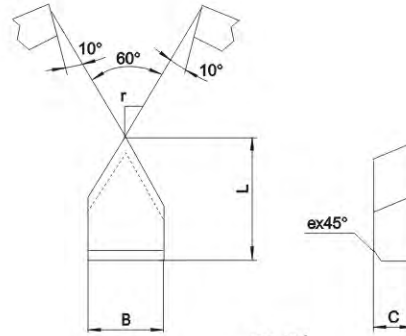

C1 型

C2 型制造精车刀和梯形螺纹车刀

C2 type for refined turning tool and ladder screw turning tool

型号 Type	尺寸 Size(mm)				
	L	B	C	r	e
C215	15	7	4	1.8	0.8
C218	18	10	5	3.1	0.8
C223	23	14	5	4.9	0.8
C228	28	18	6	7.7	0.8
C236	36	28	7	13.1	0.8

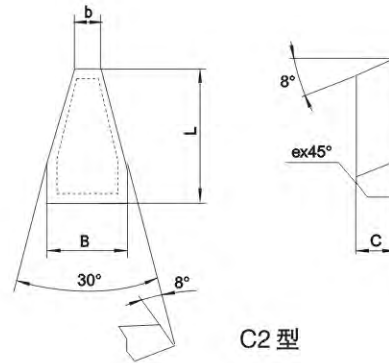

C2 型

C3 型制造切断刀和切槽刀

C3 type for cutoff tool and grooving cutter

型号 Type	尺寸 Size(mm)			
	L	B	C	e
C303	12	3.5	3	-
C304	14	4.5	4	0.8
C305	17	5.5	5	0.8
C306	17	6.5	6	0.8
C308	20	8.5	7	0.8
C310	22	10.5	8	0.8
C312	22	12.5	10	0.8
C316	25	16.5	11	1.2

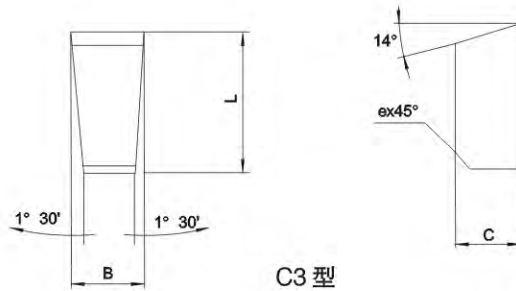

C3 型

C4 型制造加工三角皮带轮切槽刀

C4 type for processing triangle belt pulley and grooving cutter

型号 Type	尺寸 Size(mm)			
	L	B	C	b
C420	20	12	5	3
C425	25	16	5	4
C430	30	20	6	5.5
C435	35	25	6	7.5
C442	42	35	8	12.5
C450	50	42	8	15

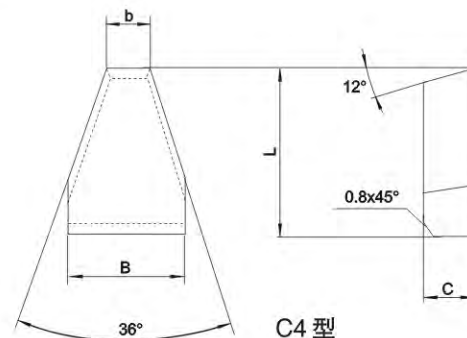

C4 型



硬质合金切削刀片 CEMENTED CARBIDE CUTTING TOOLS

型号 Type	尺寸 Size(mm)			
	L=d	S	m	b's
SPCN1203ED R/L	12.7	3.175	0.9	1.4
SPCN1504ED R/L	15.875	4.76	1.25	2.0
SPCN1905ED R/L	19.05	5.56	1.48	

型号 Type	尺寸 Size(mm)				
	L	d	S	m	b's
TPCN2204PD R/L	22	12.7	4.76	3.55	1.4

型号 Type	尺寸 Size(mm)					
	L=d	l	S	m	b's	α
82° 4xH16 Y/Z	16	-	4.5	0.93	0.93	82°
88° 4xH13 Y/Z	13	12.5		0.164	1.2	88°
88° 4xH16 Y/Z	16	15.5		0.21	1.4	
88° 4xH19 Y/Z	19	18.5		0.258		

型号 Type	尺寸 Size(mm)		
	d	S	m
LPEX1403EDR	12.700	3.175	0.97
LPEX1403EDL	12.700	3.175	0.97
LPEX1804EDR	15.875	4.76	1.32
LPEX1804EDL	15.875	4.76	1.32

型号 Type	尺寸 Size(mm)			
	d	S	m	b's
SFCN1203EFR/L	12.7	3.175	1.08	0.8
SFCN1504EFR/L	15.875	4.76	1.45	1.0

型号 Type	尺寸 Size(mm)				
	L	d	S	d1	R
WCMX040208	4.3	6.35	2.38	3.1	0.8
WCMX050308	5.4	7.94	3.18	3.2	
WCMX06T308	6.5	9.525	3.97	3.7	
WCMX080412	8.7	12.7	4.76	4.3	

型号 Type	尺寸 Size(mm)				
	L	d	S	d1	re
TCMT090204	9.6	5.56	2.38	2.5	0.4
TCMT110204	11	6.35	2.38	2.8	0.4
TCMT110208	11	6.35	2.38	2.8	0.8
TCMT16T308	16.5	9.525	3.97	4.5	0.8

型号 Type	尺寸 Size(mm)				
	L	d	S	d1	re
CCMT060204	6.4	6.35	2.38	2.8	0.4
CCMT09T308	9.7	9.525	3.97	4.4	0.8
CCMT120408	12.9	12.7	4.76	5.5	0.8

面铣刀片

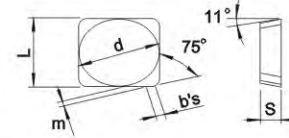

三角形铣刀片

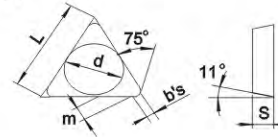

直角, 三面刃铣刀片

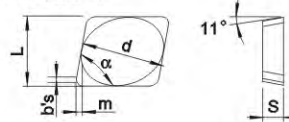

刮光铣刀片

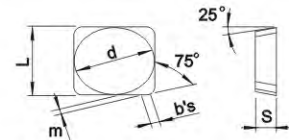
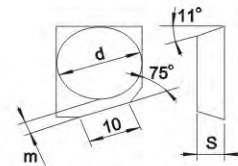

浅孔钻刀片

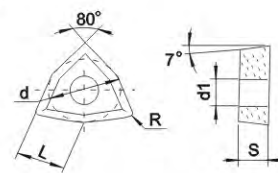

90° 93° 外圆车刀

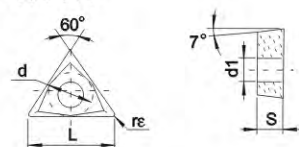

95° 外圆、端面、内孔车刀

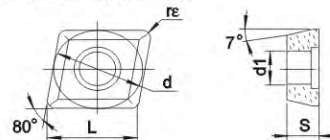



矿山、油田钻头用硬质合金齿

HARD METAL(CARBIDE)INSERTS FOR MINING AND OIL-FIELD ROCK BITS

牌号 Grade	化学成分(%) Chemical Composition		硬度 Hardness HRA ± 0.3	密度 Density g/cm ³ ± 0.1	抗弯强度 TRS n/mm ²	晶粒度 Grain Size m	推荐用途 Applications recommended
	Wc	Co					
ZK10	94	6	90.3	14.95	3250	1.6~2.4	各种规格冲击和潜孔钻头球齿, 凿进中硬岩层 Used for making various sizes of buttons for hammer & DTH bits for drilling in mediumhard formatio
ZK10A	93.5	6.5	91.5	14.90	3200	1.6~2.4	各种规格冲击和潜孔钻头球齿, 凿进中硬岩层 Used for making various sizes of buttons for hammer & DTH bits for drilling in mediumhard formatio
ZK15	92	8	88.8	14.75	3300	2.4~3.2	用于各种钻头球齿、片齿、耐磨零件 Used for making various buttons and disk cutters for rock bits as well as for making wear resistant parts
ZK15A	92	8	90.5	14.75	3400	1.6~2.4	用于冲击和潜孔钻头球齿, 凿进软硬交错、含夹层的岩层 Used for making buttons for hammer & DTH bits for drilling in inter bedded formation and terraced soft & hard formation
YG9C	90.5	9.5	87.8	14.55	2700	2.4~3.2	适用于冲击和潜孔钻头球齿凿岩用的钎头, 钻凿中硬岩石、坚硬岩石, 亦适用于切含有坚硬夹石的截煤机齿、石油钻头 Suitable for bore bit of percussion rotary rock, chill drilling medium hard and fairly hardrock, teeth of coal cutter cutting with hard dunn bass and oil drill bit
YG11C	89	11	87.0	14.40	2800	2.4~3.2	适用于镶制重型凿岩机冲击回转凿岩机用的钻头钻凿硬岩层坚硬岩 Applied to inlay the drill bit for heavy-duty and bore bit of percussion rotary rock drill drilling hard rock
YG13C	87	13	86	14.20	2800	2.4~3.2	强度高耐磨性较好适用于制造石油牙轮钻或复合片 Strength good wear resistance better applied to manufacture oil drilling or composite cone
YG15C	85	15	85.5	14.00	2800	2.4~3.2	强度很好耐磨性较低适用于制造石油牙轮钻或复合片 High strength wear resistance comparatively lower applied to manufacture compound pieces
ZK20	91	9	87.5	14.60	2700	2.4~3.2	韧性好适用于坚硬岩石的凿岩 Good toughness for hard rock drilling
ZK25	90	10	87	14.50	2800	2.4~3.2	韧性极好适用于极硬岩石的凿岩 Excellent toughness to extremely hard rock drilling



矿山、油田钻头用硬质合金齿

HARD METAL(CARBIDE)INSERTS FOR MINING AND OIL-FIELD ROCK BITS

DQ 型(DQ Type)

型号 Type	尺寸 Size(mm)				
	D	H	h	R	e
DQ0810	8.0	10.0	7.1	4.2	1.5
DQ0812	8.0	12.0	9.1	4.2	
DQ1010	10.0	10.0	6.2	5.2	
DQ1012	10.0	12.0	8.2	5.2	
DQ1014	10.0	14.0	10.2	5.2	
DQ1214	12.0	14.0	9.4	6.2	
DQ1216	12.0	16.0	11.4	6.2	
DQ1218	12.0	18.0	13.4	6.2	
DQ1313	13.0	13.5	8.4	6.7	
DQ1315	13.0	15.5	10.4	6.7	
DQ1416	14.0	16.0	10.5	7.2	
DQ1417	14.0	17.0	11.1	7.6	
DQ1420	14.0	20.0	14.5	7.2	
DQ1422	14.0	22.0	16.5	7.2	
DQ1517	15.0	17.0	11.1	7.6	
DQ1618	16.0	18.0	11.6	8.2	
DQ1623	16.0	23.0	16.6	8.2	
DQ1625	16.0	25.0	18.6	8.2	
DQ1825	18.0	25.0	17.7	9.2	
DQ1827	18.0	27.0	19.7	9.2	
DQ2030	20.0	30.0	20.0	10.2	
DQ2540	25.0	40.0	29.8	12.7	

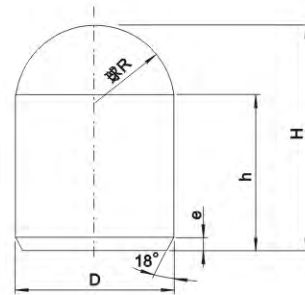

DQ 型(球形齿)
Q type spherical tooth

DZ 型(DZ Type)

型号 Type	尺寸 Size(mm)					e	$\alpha^{(0)}$
	D	H	h	R			
DZ0810	8.0	10.0	6.5	3.0	1.5	35.0	
DZ0812	8.0	12.0	8.5	3.0			
DZ1011	10.0	11.0	7.1	4.4			
DZ1013	10.0	13.0	9.1	4.4			
DZ1015	10.0	15.0	9.9	4.0			
DZ1215	12.0	15.0	10.2	5.1			
DZ1218	12.0	18.0	13.0	4.8			
DZ1416	14.0	16.0	9.5	4.7			
DZ1418	14.0	18.0	12.5	6.0			
DZ1420	14.0	20.0	13.7	5.0			
DZ1422	14.0	22.0	15.7	5.0			
DZ1625	16.0	25.0	17.3	5.0			2.0

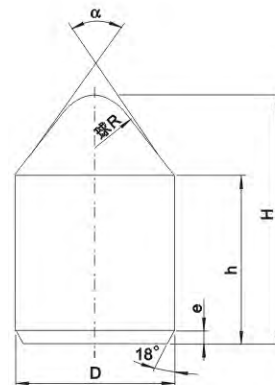

DZ 型(锥形齿)
Z type conispherical tooth



矿山、油田钻头用硬质合金齿

HARD METAL(CARBIDE)INSERTS FOR MINING AND OIL-FIELD ROCK BITS

DX 型(DX Type)

型号 Type	尺寸 Size(mm)								
	D	H	h	R	r	e	$\alpha^{(0)}$	$\beta^{(0)}$	
DX0810	8.0	10.0	6.5	2.0	1.8	1.5	45	22.5	
DX1011	10.0	11.0	7.0	2.5	2.0		45		
DX1013	10.0	13.0	9.0	2.5	2.0		45		
DX1115	11.0	15.0	8.0	2.75	2.5		22.5		
DX1215	12.0	15.0	9.0	3.0	2.5		45		
DX1217	12.0	17.0	10.5	3.5	3.0	2.0	35	20	
DX1418	14.0	18.0	10.0	3.5	3.0		45		
DX1420	14.0	20.0	11.0	2.7	3.0	2.0	35	22.5	
DX1520	16.0	20.0	12.0	3.0	3.0		40		
DX1621	16.0	21.0	11.0	2.6	3.0	2.0	35	22.5	
DX1623	16.0	23.0	12.0	3.0	3.5		30		
DX1721	17.0	21.0	13.0	4.0	3.5	2.0	40	22.5	
DX1724	17.0	24.0	13.0	3.5	3.5		30		
DX1929	19.0	29.0	17.0	4.0	3.0	2.0	30	15	

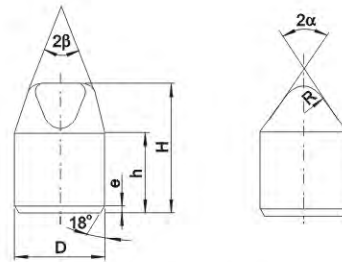

DX 型(楔形齿)
X type wedge tooth

DB 型(DB Type)

型号 Type	尺寸 Size(mm)								
	D	H	h	R	r	e	$\alpha^{(0)}$	$\beta^{(0)}$	
DB1417	14.0	17.0	12.0	3.0	2.5	1.5	90	3.0	
DB1418	14.0	18.0	12.0	3.0	2.5	1.5	80	4.0	
DB1419	14.0	19.0	12.0	3.0	2.5	1.5	75	4.0	
DB1621	16.0	21.0	14.0	3.0	2.5	2.0	70	4.5	
DB1924	19.0	24.0	15.0	3.5	3.0	2.0	70	4.5	
DB2230	22.0	30.0	17.0	3.5	3.0	2.0	60	5.0	

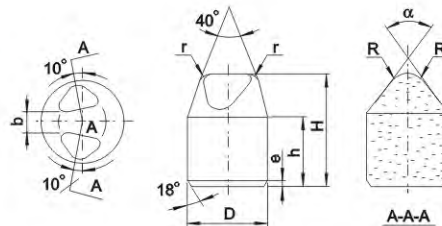

DB 型(边楔齿)
B type edge-wedge tooth

DS 型(DS Type)

型号 Type	尺寸 Size(mm)								
	D	H	h	R _a	R _b	R _c	r	$\alpha^{(0)}$	e
DS1421	14.0	21.0	12.0	12.0	20.0	2.5	2.5	18	1.5
DS1628	16.0	23.0	12.0	15.0	23.0	2.5	2.5	18	1.5
DS1626	16.0	26.0	14.0	20.0	28.0	2.5	2.5	18	
DS1724	17.0	24.0	13.0	16.0	25.0	3.0	3.0	20	
DS1930	19.0	30.0	17.0	16.0	25.0	3.0	3.0	15	20.0
DS2240	22.0	40.0	21.0	20.0	30.0	3.0	3.0	13	
DS2545	25.0	45.0	23.0	30.0	35.0	3.5	3.5	13	

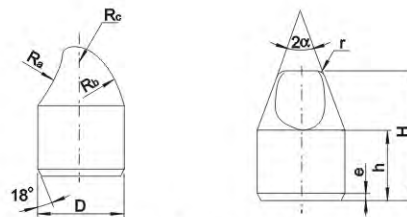

DS 型(勺型齿)
S type half-round tooth

DP 型(DP Type)

型号 Type	尺寸 Size(mm)		
	D	H	e
DP0607	6.0	7.0	1.5
DP0707	7.0	7.0	
DP0807	8.0	7.0	
DP0908	9.0	8.0	
DP1008	10.0	8.0	
DP1109	11.0	9.0	
DP1210	12.0	10.0	
DP1412	14.0	12.0	

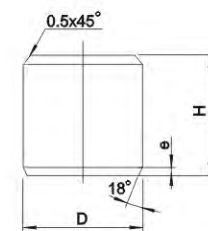

DP 型(平顶齿)
P type flat-top tooth



凿岩工具用硬质合金

HARD METAL FOR ROCK DRILLING TOOLS

KO 型(KO Type)

型号 Type	尺寸 Size(mm)							
	l	h	s	R	α	β	r	e
K020	20.0	15.0	7.0					
K022	22.0	15.0	7.0					
K024	24.0	15.0	7.0					
K24B	24.0	14.0	7.0					
K26	26.0	18.0	8.0					
K28	28.0	18.0	8.0					
K28B	28.0	16.0	8.0					
K30	30.0	18.0	8.0					
K30B	30.0	14.0	8.0					
K32	32.0	18.0	8.0				40°	1.5
K32B	32.0	14.5	9.0					
K32B1	32.0	13.0	7.5					
K33	33.0	18.0	9.2	180.0	110°	3°		
K34	34.0	18.0	10.0					
K34B	34.0	15.0	9.0					
K36	36.0	18.0	10.0					
K36B	36.0	15.0	9.0					
K38	38.0	18.0	10.0					
K38B	38.0	15.0	9.0					
K40	40.0	18.0	10.0					
K40B	40.0	15.0	10.0					
K42	42.0	18.0	10.0				80°	2.0
K42B	42.0	15.0	10.0					
K44	44.0	18.0	10.0					
K44B	44.0	15.0	10.0					

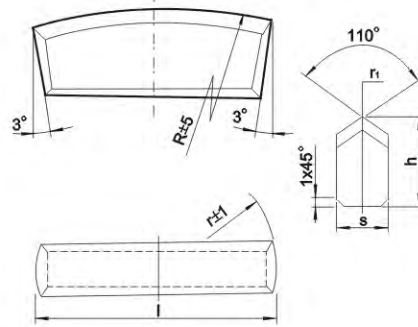

K20 型(K20 Type)

型号 Type	尺寸 Size(mm)					
	l	h	s	r	r ₁	e
K2012	12.0	12.0	8.0	16.0		1.0
K2013	13.0	12.0	8.0	16.0		1.0
K2014	14.0	12.0	8.0	17.0		1.0
K2015	15.0	12.0	8.0	20.0		1.0
K2017	17.0	14.0	8.0	20.0		1.0
K2019	19.0	14.0	8.0	22.0		1.0
K2020	20.0	16.0	10.0	23.0		1.5
K2020A	20.0	18.0	10.0	23.0	0.5-1.0	1.5
K2022	22.0	16.0	10.0	25.0		1.5
K2024	24.0	16.0	10.0	27.0		1.5
K2026	26.0	16.0	10.0	29.0		1.5
K2028	28.0	16.0	10.0	31.0		1.5
K2030	30.0	18.0	12.0	35.0		1.5
K2032	32.0	18.0	12.0	38.0		2.0
K2035	35.0	20.0	15.0	45.0		2.0
K2041	41.0	22.0	17.0	51.0		2.0
K2045	45.0	25.0	19.0	57.5		2.0
K2053	63.0	25.0	20.0	59.0		2.0

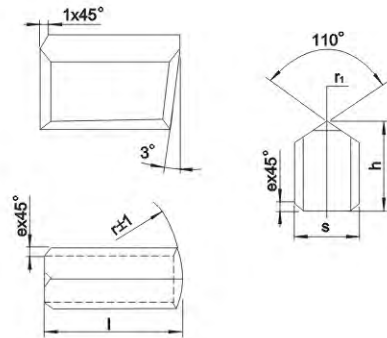



凿岩工具用硬质合金

HARD METAL FOR ROCK DRILLING TOOLS

K21型(K21 Type)

型号 Type	尺寸 Size(mm)					
	l	h	s	r	r ₁	e
K2114	14.0	12.0	8.0	20.0	0.5~1.0	1.0
K2116	16.0	12.0	8.0	22.0		1.0
K2118	18.0	14.0	10.0	22.5		1.0
K2120	20.0	16.0	10.0	28.5		1.0
K2126	26.0	16.0	10.0	35.0		1.5
K2126A	26.0	18.0	10.0	35.0		1.5
K2128	26.0	16.0	10.0	35.0		1.5
K2128A	28.0	18.0	10.0	35.0		1.5
K2130	30.0	16.0	12.0	38.0		1.5
K2130A	30.0	18.0	12.0	38.0		1.5
K2132	32.0	16.0	12.0	44.5		2.0
K2132A	32.0	18.0	12.0	44.5		2.0
K2135	35.0	16.0	12.0	51.0		2.0
K2135A	35.0	18.0	12.0	51.0		2.0
K2139	39.0	18.0	14.0	57.5		2.0
K2143	43.0	20.0	14.0	63.5	2.0	

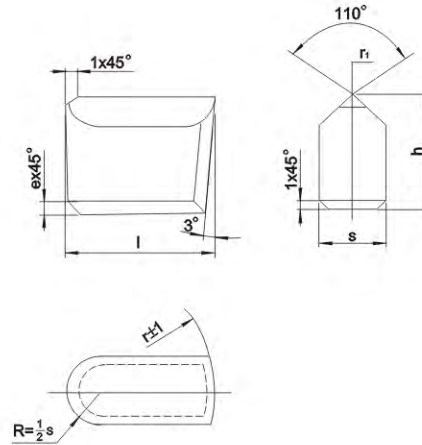

K30型(K30 Type)

型号 Type	尺寸 Size(mm)		
	d	h	r ₁
K3008	8.0	14.0	0.5~1.0
K3010	10.0	16.0	
K3012	12.0	16.0	
K3014	14.0	18.0	
K3016	16.0	20.0	
K3016A	16.0	22.0	
K3018	18.0	20.0	

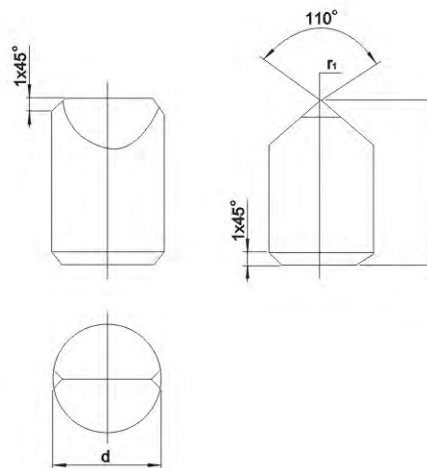



煤炭采掘工具用硬质合金

CEMENTED CARBIDE FOR COAL-MINING TOOLS

DM10 型(DM10 Type)

型号 Type		尺寸 Size(mm)			
Right	Left	B	H	S ¹⁾	b
DM1011R	DM1011L	11	12	2.5	4.0
DM1014R	DM1014L	14	19	3.8	4.0
DM1015R	DM1015L	15	22	3.0	5.0
DM1018R	DM1018L	18	22	6.0	5.0

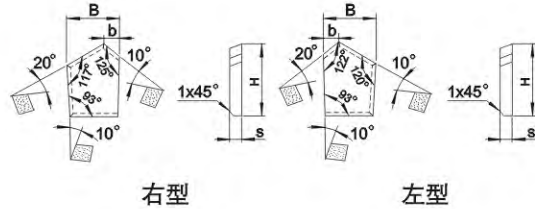

DM11 型(DM11 Type)

型号 Type	尺寸 Size(mm)			
	B	H	h	S
DM1112	12.0	18.0	15.8	3.0
DM1113	13.4	26.0	23.8	3.0

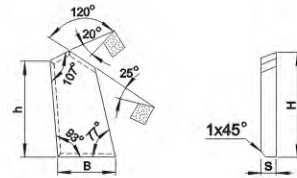

DM12 型(DM12 Type)

型号 Type	尺寸 Size(mm)					
	B	H	S	R	$\alpha^{(0)}$	e
DM1216	16.0	22.0	7.0	6.0	15	1.0
DM1220	20.0	27.0	8.0	7.0	15	1.0
DM1222	22.0	22.0	7.5	8.0	10	1.5
DM1230	30.0	35.0	12.0	9.0	8	1.0

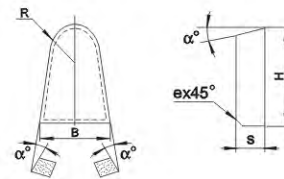

DM13 型(DM13 Type)

型号 Type	尺寸 Size(mm)			
	B	H	S	$\alpha^{(0)}$
DM1306	6	5	1.4	130
DM1311	11	9	2.0	130
DM1313	13	10	2.5	130
DM1315	15	10	2.5	130
DM1317	17	13	3.0	130
DM1319	19	13	3.0	130
DM1322	22	15	3.5	130
DM1326	26	18	4.5	130
DM1333	33	22	3.0	130
DM1345	45	27	9.0	130

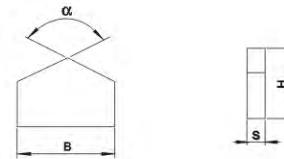

DM14 型(DM14 Type)

型号 Type		尺寸 Size(mm)							
Right	Left	B	H	S	b	$\alpha_1^{(0)}$	$\alpha_2^{(0)}$	$\alpha_3^{(0)}$	$\alpha_4^{(0)}$
DM1427R	DM1427L	27.5	22.0	4.5	10.0	30	35	35	30
DM1445R	DM1445L	45.0	21.0	9.0	15.0	31	17	17	31

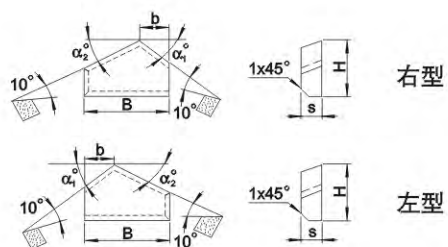



煤炭采掘工具用硬质合金

CEMENTED CARBIDE FOR COAL-MINING TOOLS

DM20 型(DM20 Type)

型号 Type	尺寸 Size(mm)				
	D	H	r	$\alpha_1^{(0)}$	e
DM2009	9.0	16.0	1.0	90	1.0
DM2012A	12.0	18.0	1.5	82	1.0
DM2012B	12.0	20.0	1.5	82	1.5
DM2018	18.0	32.0	1.5	82	2.0

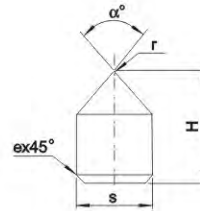

DM21 型(DM21 Type)

型号 Type	尺寸 Size(mm)						
	D	H	R	$\alpha_1^{(0)}$	$\alpha_2^{(0)}$	e	$\beta^{(0)}$
DM2110A	10.0	18.0	8.0	53	53	1.0	30
DM2110B	10.0	20.0	5.5	50	58	1.0	45
DM2112A	12.0	20.0	6.5	32	40	1.0	45
DM2112B	12.5	25.0	10.0	46	46	1.0	30
DM2115	15.0	22.0	11.0	45	45	2.5	30
DM2118	18.0	20.0	14.4	37	37	1.5	45

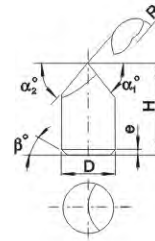

DM22 型(DM22 Type)

型号 Type	尺寸 Size(mm)							
	D	H	R	$\alpha_1^{(0)}$	$\alpha_2^{(0)}$	B	e	$\beta^{(0)}$
DM2210A	10.0	18.0	8.0	48	33	-	1.0	45
DM2210B	10.0	20.0	8.0	48	38	-	1.0	45
DM2212A	12.0	22.0	9.0	50	50	4.0	1.0	30
DM2212B	12.5	25.0	9.0	45	55	4.0	1.0	30
DM2214	14.0	22.0	10.0	55	49	-	2.0	45
DM2216	16.0	28.0	8.0	50	50	5.0	2.0	30
DM2218	18.0	21.5	11.0	52	52	-	2.0	30

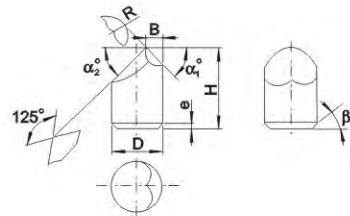

DM23 型(DM23 Type)

型号 Type	尺寸 Size(mm)			
	D	H	$\alpha_1^{(0)}$	$\alpha_2^{(0)}$
DM2312A	12.0	22.0	56	48
DM2312B	12.5	25.0	56	48
DM2314A	14.0	22.0	56	48
DM2314B	14.0	25.0	56	48

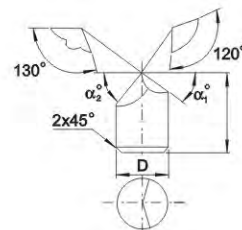

DM24 型(DM24 Type)

型号 Type	尺寸 Size(mm)				
	D	H	$h^{(1)}$	R	r
DM2417A	17.0	26.5	12.0	26.0	1.75
DM2417B	17.0	29.5	15.0	26.0	1.75

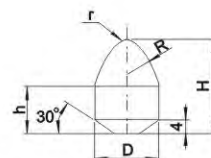



硬质合金电锤刀片 ELECTRIC HAMMER BLADE

型号 Type	相当 ISO 分组代号 Substitution by ISO group code	性能 Performance			用途 Application
		密度 Density	抗弯强度 Power of bending resistant	硬度 Density	
		G/cm ³	N/mm ³	HRA	
YD02	K30	14.3-14.7	≥ 2060	≥ 86.0	适用于制作木工刀片。 Fitting manufacturing of wood cutter.
YD03	K40	14.2-14.6	≥ 2060	≥ 87	适于制造加高加厚大的电锤冲击钻片。 Fitting manufacturing of heightened and thickened striking drill flake of electric hammer.
YD32	K40	14-14.4	≥ 2060	≥ 87	适于制作大的电锤冲击钻片。 Fitting manufacturing of big striking drill flake of electric hammer.

>>E3型制造削角电锤钻>>E3 type for chamfer electric hammer drill

型号 Type	尺寸 Size(mm)		
	φD	H	C
E305.0	5.15	5.1	1.4
E305.5	5.65	5.4	1.4
E306.0	6.15	5.4	1.4
E306.5	6.65	5.9	1.4
E307.0	7.20	5.9	1.6
E308.0	8.20	6.5	2.0
E308.5	8.70	6.9	2.0
E309.0	9.20	6.9	2.0
E310.0	10.20	7.5	2.05
E311.0	11.20	8.5	2.05
E312.0	12.20	9.0	2.35
E313.0	13.20	9.5	2.65
E314.0	14.20	9.5	2.85
E315.0	15.20	10.5	2.85
E316.0	16.20	10.5	2.85
E317.0	17.20	10.5	2.85
E318.0	18.20	11.0	3.40
E319.0	19.21	12.0	3.40
E320.0	20.21	13.0	3.40
E322.0	22.21	14.0	3.90
E323.0	23.21	14.0	3.90
E324.0	24.21	15.0	4.40
E325.0	25.21	15.0	4.40
E326.0	26.21	15.1	4.40
E327.0	27.21	16.0	4.40
E328.0	28.21	17.0	4.90
E329.0	29.21	17.0	4.90
E330.0	30.21	17.0	4.90
E332.0	32.25	19.0	5.40
E333.0	32.75	19.0	5.40
E335.0	35.25	20.5	5.90
E336.0	36.75	20.5	5.90

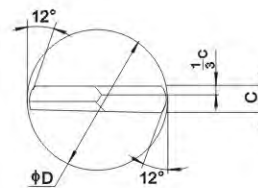
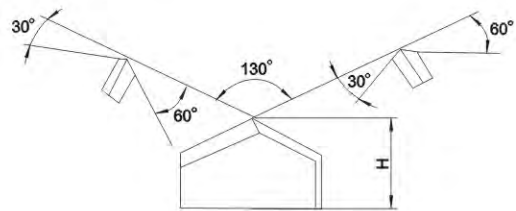

E3 型

型号 Type				尺寸 Size(mm)				
φD	H	C	φD	H	C	φD	H	C
φ3.3	3.3	4	1.1	φ9.8	9.8	8	2	
φ4.3	4.3	4	1.2	φ10.3	10.3	8	2.2	
φ5.3	5.3	5	1.6	φ12.3	12.3	9	2.2	2.4
φ5.8	5.8	5.5	1.6	φ14.3	14.3	9.5	2.5	2.9
φ6.3	6.3	5.5	1.6	φ16.3	16.3	10.5	2.5	2.9
φ6.8	6.8	5.5	1.6	φ17.3	17.3	10.5	2.9	
φ7.3	7.3	6.5	1.8	φ18.3	18.3	12.1	2.9	
φ8.3	8.3	7	2	φ20.3	20.3	13	3.2	
φ9.3	9.3	7.5	2					



硬质合金电锤刀片 ELECTRIC HAMMER BLADE

>>E1型制造健工钻和电锤钻>>E1 type for well-set tool and electric hammer drill

型号 Type	尺寸 Size(mm)		
	B	H	C
E105	5	5	1.5
E106	6	6	1.5
E107	7	6	1.5
E108	8	7	1.8
E109	9	8	2
E110	10	9	2

型号 Type	尺寸 Size(mm)			型号 Type	尺寸 Size(mm)		
	B	H	C		B	H	C
φ5	5.3	5	1.5	φ18	18.2	11.5	2.7
φ5.8	5.8	5.5	1.6	φ19	19.3	13.8	2.7
φ6	6.2	5.6	1.4 1.8	φ20	20.2	12.3	2.7
φ7	7	6	1.8	φ22	20.3	13.2	3.2
φ8	8.25	6.8	1.8 2.0	φ25	25.3	14.4	3.2
φ9.5	9.5	7.5	2.0	φ26	26.3	15.5	3.8
φ10	10.25	8	2.0 2.4	φ28	28.3	15.9	3.8
φ12	12.25	9.5	2.0 2.4	φ30	30.3	18	3.8
φ11	11	8		φ32	32.3	17.9	3.8
φ14	14.2	10.5	2.3 2.9	φ35	35.3	20.8	3.8
φ16	16.2	10.8	2.3 2.9	φ38	38.3	21.9	4.4

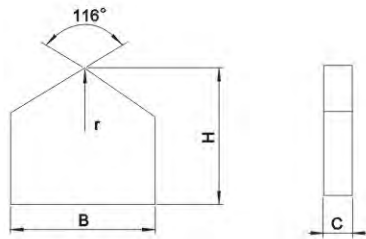

E1型

>>E2型制造麻花钻和直槽钻>>E2 type for fluted twist drill and straight-flute drill

型号 Type	尺寸 Size(mm)			
	B	H	C	r
E210	10.8	9	2	1
E211	11.8	10	2.5	1
E213	13	11	2.5	1
E214	14	12	2.5	1
E214	15	13	2.5	1
E216	16	14	3	1
E217	17	15	3	1.5
E218	18	16	3	1.5
E219	19	17	3	1.5
E220	20	18	3.5	1.5
E221	21	18	3.5	1.5
E222	22	18	3.5	1.5
E223	23	18	4	1.5
E224	24	18	4	1.5
E225	25	22	4.5	2
E226	26	22	4.5	2
E227	27.5	22	4.5	2
E228	28.5	22	4.5	2
E229	29.5	24	5	2
E230	30.5	24	5	2
E231	31.5	24	5	2
E233	33.5	26	5	2

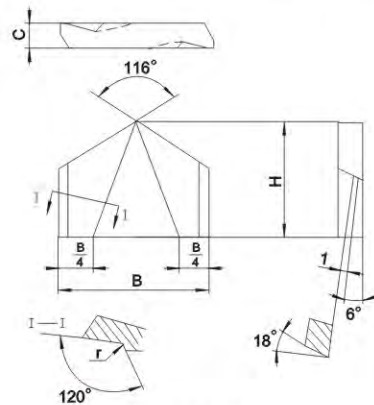

E2型

型号 Type	尺寸 Size(mm)		
	B	H	C
φ14	14.8	12.5	2.2
φ20	20.8	18	3.2
φ23	24	19	3.6
φ24	25	20	4.1



旋转锉合金 ROLLING BURRS ALLOY

型号 Type	相当 ISO 分组代号 Substitution by ISO group code	性能 Performance			用途 Application
		密度 Density	抗弯强度 Power of bending resistant	硬度 Density	
		G/cm ³	N/mm ²	HRA	
YG8N	K20-K30	14.5-14.9	≥ 1670	≥ 90.0	硬铸铁、球墨铸铁、白口铁及有色金属精加工。 Extract processing of hard cast iron, ductile iron, white-mouthed iron and coloured metal.
YG6	K20	14.7-15.1	≥ 1520	≥ 89.5	适于铸铁、有色金属及其合金与非金属材料连续切削时的精车、间断切削时的半精车、精车、小断面精车、粗车螺纹、旋风车丝、连续断面的半精铣与精铣、孔的粗扩、也用于钢、有色金属及其合金线材的干式润滑拉伸、地质勘探、煤炭采掘用电钻及风钻钻头、制造机器与工具的易磨损零件。 Fitting extract processing in nonstop cutting of cast iron, coloured metal and its alloy and non-metal material; half-extract processing, extract processing, small-dimension extract processing, and gruff machine whorling in interrupted cutting; half-extract milling and extract milling of continuous surface and vortex machining string; gruff expanding of hole; dry lubricated plucking of steel, coloured metal, and its alloy string material; earth surveying; serving as the drill-head in wind-drill and electric drill of coal digging and the frayable accessory of manufacturing machine and tool.
YG8	K20-K30	14.5-14.9	≥ 1780	≥ 89.0	适于铸铁、有色金属及其合金与非金属材料加工中不平整断面和间断切削时的粗车、粗刨、精洗、一般孔和深孔的钻孔、扩孔。钢、有色金属及其合金的棒材与管材的拉伸、电钻钻头、切煤机齿、油井钻头、地质勘探钻头，制造机器及工具的易磨损零件。如喷咀、顶尖、导向装置，顶锻杆及穿孔工具、木工刀片等。 Fitting gruff processing, gruff planing, and extract milling in interrupted cutting and smoothless surface in processing of cast iron, coloured metal and its alloy, and nonmetal material; drilling and expanding of ordinary and deep hole; plucking of stick and pipe material of coloured metal and its alloy; serving as head of electric drill, tooth of coal-cutting machine, head of oil-well drills, and head of drills in earth surveying, etc; frayable accessory of manufacturing machine and tool, e.g. spout, finial, guiding-set, top forging-pole, hole-shuttling tool, and wood cutter.

BSA 型

型号 Type	A	B
BSA2	7.94	19.05
BSA3	9.53	19.05
BSA4	11.11	25.4
BSA5	12.7	25.4
BSA51	6.35	12.7
BSA6	15.88	25.4
BSA7	19.05	25.4
BSA71	19.05	12.7
BSA72	19.05	19.05
BSA8	22.23	25.4
BSA9	25.4	25.4
BSB51	6.35	4.76

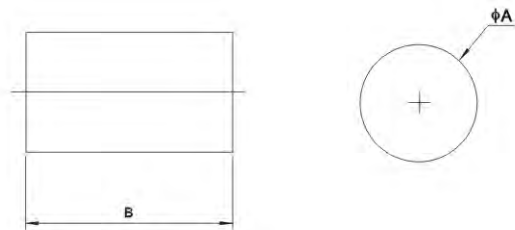

BSA 型

BSC 型

型号 Type	A	B	C
BSC2	7.94	19.05	4.17
BSC3	9.53	19.05	4.95
BSC4	11.11	25.4	5.77
BSC5	12.7	25.4	6.55
BSC51	6.35	12.7	3.38
BSC6	15.88	25.4	8.13
BSC7	19.05	25.4	9.75

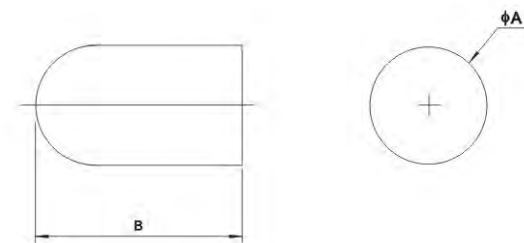

BSC 型



旋转铣合金 ROLLING BURRS ALLOY

BSD 型

型号 Type	A	B	C
BSD1	6.35	5.59	4.78
BSD2	7.94	7	5.74
BSD3	9.53	8.4	6.76
BSD4	11.11	9.96	7.39
BSD5	12.7	11.43	8.2
BSD6	15.88	14.43	9.91
BSD7	19.05	17.42	11.58
BSD9	25.4	23.47	14.68
BSD51	6.35	5.59	4.78

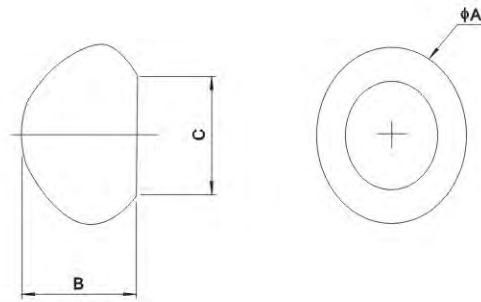

BSE 型

型号 Type	A	B	C	R1	R2
BSE1	6.35	9.53	5.49	10.85	2.51
BSE3	9.53	15.88	7.9	22.35	4.09
BSE5	12.7	22.23	10.31	31.88	5.28
BSE6	15.88	25.4	12.88	31.88	6.48
BSE7	19.05	25.4	12.57	20.37	8.08

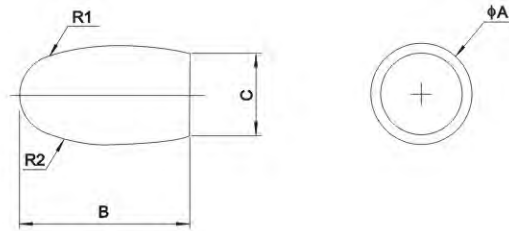

BSF 型

型号 Type	A	B	R1	R2
BSF13	12.7	19.05	44.7	3.3
BSF3	9.53	19.05	58.42	2.49
BSF4	11.11	25.4	82.68	2.49
BSF5	12.7	25.4	82.68	3.3
BSF51	6.35	12.7	82.68	1.73
BSF6	15.88	25.4	76.33	4.93
BSF7	19.05	25.4	54.1	4.93

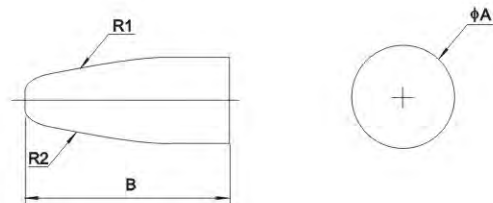

BSG 型

型号 Type	A	B	C	R
BSG2	7.94	19.05	1.4	50.98
BSG3	9.53	19.05	1.42	38.23
BSG5	12.7	25.4	1.85	64.9
BSG51	6.35	12.7	1.07	26.67
BSG6	15.88	25.4	1.85	47.75
BSG7	19.05	25.4	1.91	41.43

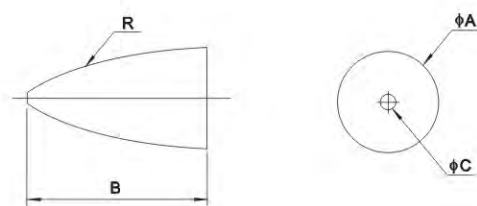



旋转铣合金 ROLLING BURRS ALLOY

BSH 型

型号 Type	A	B	C	D	R1	R2	R3
BSH2	7.94	19.05	6.53	12.42	27.13	1.73	
BSH5	12.7	31.75	10.95	21.69	50.93	2.51	
BSH6	15.88	31.75	12.57	22.35	57.28	2.51	19.18
BSH7	19.05	41.4	13.92	25.45	47.78	4.11	

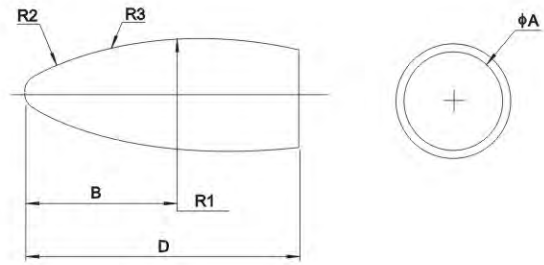

BSL 型

型号 Type	A	B	R	E(ref)
BSL2	7.94	25.4	1.4	22.35
BSL3	9.53	30.23	1.65	26.9
BSL4	12.7	31.75	3.2	28.7
BSL5	15.88	33.27	4.78	30.2
BSL6	15.88	36.32	4.34	33.27
BSL7	19.05	41.4	5.49	38.1

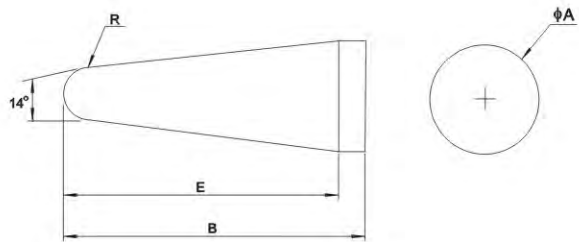

BSM 型

型号 Type	A	B	E	C	E(ref)
BSM1	6.35	15.88	1.65	22	12.7
BSM4	9.53	19.05	1.85	28	15.88
BSM5	12.7	25.4	1.85	28	22.23
BSM6	15.88	28.7	2.03	31	25.4
BSM51	6.35	15.88	1.65	22	12.7

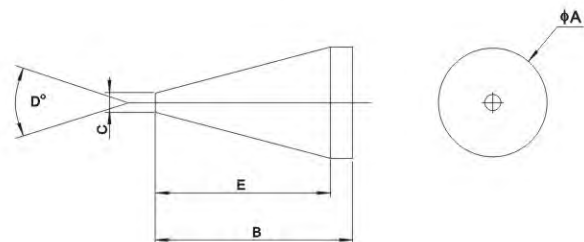

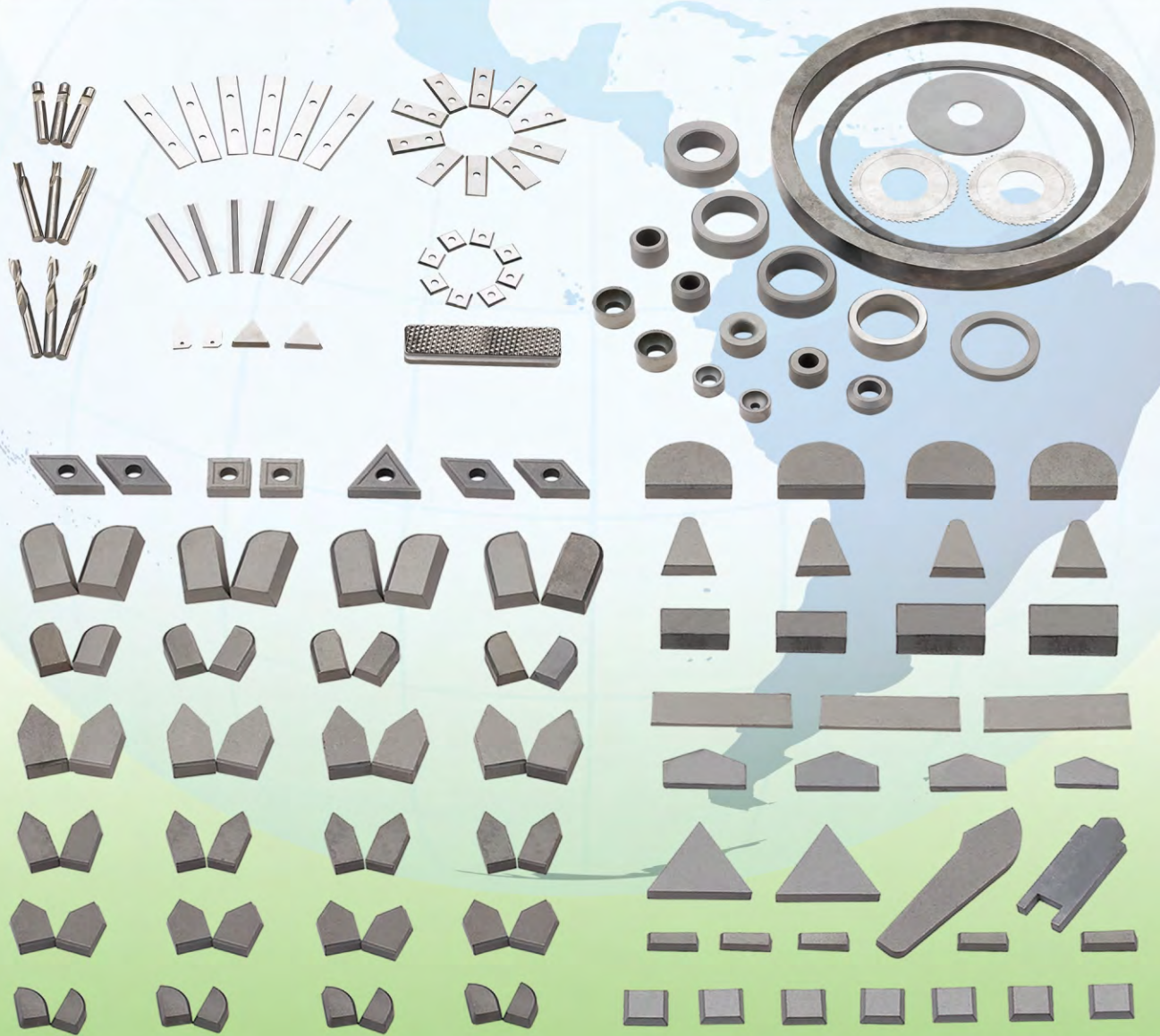

▲ 一丝不苟的生产管理

Conscientious and meticulous production management



共同创造环保世界



乐清市中源硬质合金有限公司

ZHONGYUAN HARD ALLOY CO.,LTD.

地址：浙江省乐清市清江镇工业区

Add:Qingjiang Industry Zone, Yueqing, Zhejiang

电话 (Tel): 86-577-62275306

86-577-62275305 62275212

传真 (Fax): 86-577-62275309

邮编 (P.c): 325611

E-mail:info@zyhardalloys.com

Http://www.zyhardalloys.com